

OUTWARD TOP-HUNG

Manuale/ <i>Manual</i> (*)	≤ 100 kg
Motorizzato/ <i>Automatic</i>	≤ 250 kg
H [mm]	1500 ÷ 3500
W [mm]	≤ 2000

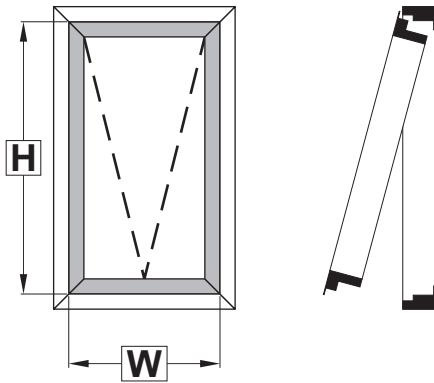

OUTWARD BOTTOM-HUNG

Manuale/ <i>Manual</i>	NO
Motorizzato/ <i>Automatic</i>	≤ 300 kg
H [mm]	1500 ÷ 4500
W [mm]	≤ 2000

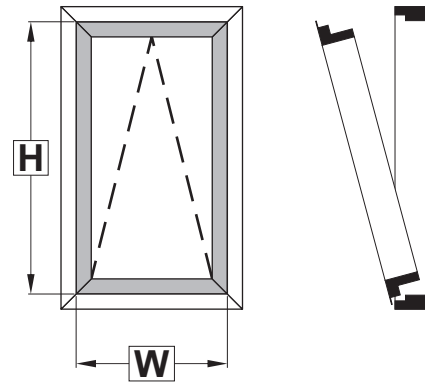

(*) Con Apertura Manuale è necessario l'utilizzo di **bracci limitatori di apertura**. Per la corretta scelta dei bracci limitatori di apertura contattare il Servizio Tecnico Giesse.

(*) With manual opening it is necessary to use **opening limitation arms**. For the correct choice of the **opening limitation arms** contact Giesse Technical Service.

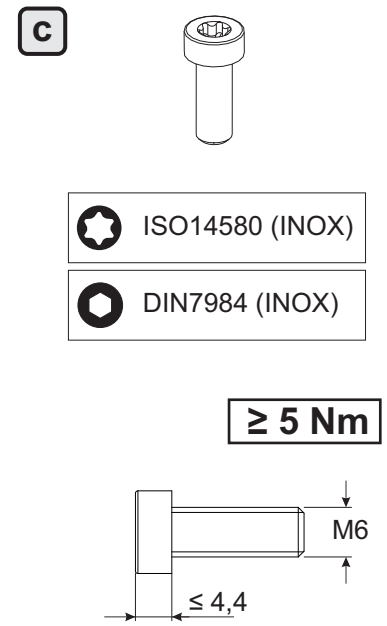
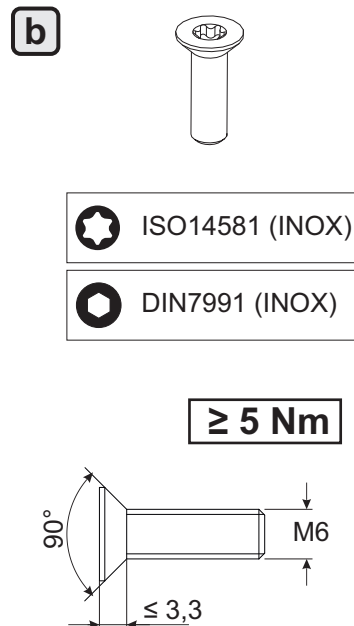
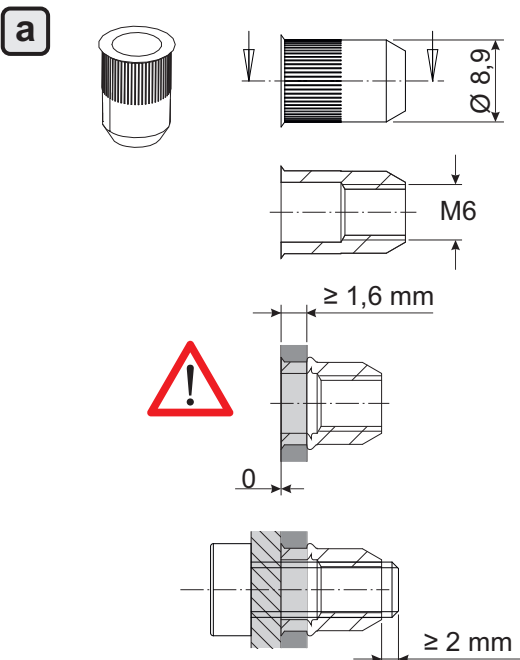
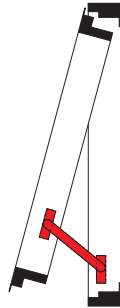

APERTURA MOTORIZZATA - AUTOMATIC OPENING



Il numero dei motori da applicare sul serramento dipende dal peso, dalle dimensioni dell'anta e dalle caratteristiche tecniche del motore utilizzato.
Per la corretta determinazione della configurazione contattare il Servizio Tecnico Giesse.

*The number of motors to be applied on the frame depends on the weight, the dimensions of the door and the technical characteristics of the actuator used.
For the correct determination of the configuration contact Giesse Technical Service.*

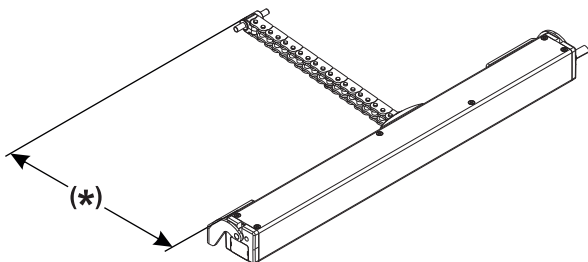

(* La corsa massima del motore non deve superare i 300 mm.

The maximum engine stroke must not exceed 300 mm.



La scelta del tipo di motore deve essere valutata con particolare attenzione dal serramentista.
La scelta del tipo di fissaggio del motore all'anta e al telaio sono demandati al serramentista.

*The choice of the type of motor must be evaluated with particular attention by the window maker.
The choice of the type of fixing of the motor to the sash and to the frame is entrusted to the fitter.*

Esempio: finestra con 1 motore
Example: window with 1 motor

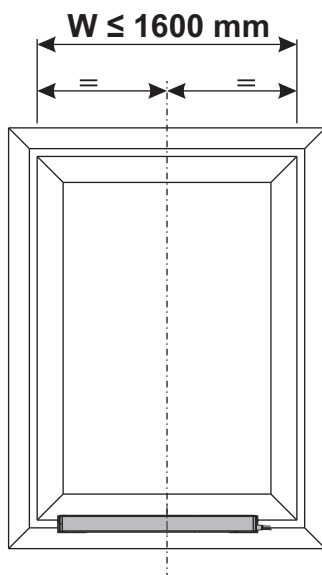

TOP-HUNG MAX. 250 kg

BOTTOM-HUNG MAX. 300 kg

Esempio: finestra con 2 motori
Example: window with 2 motors

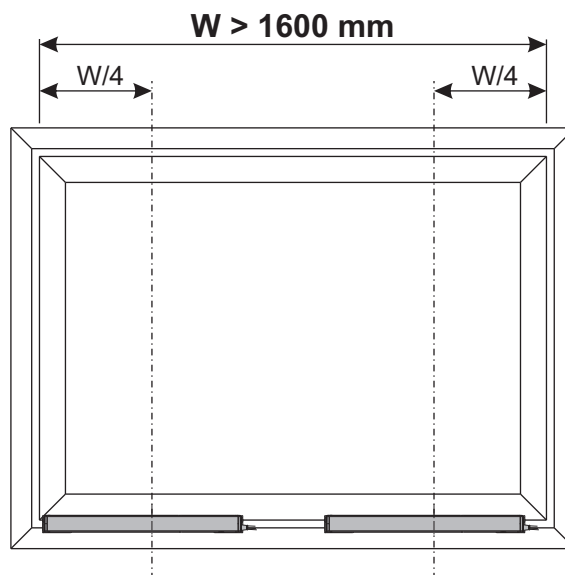

TOP-HUNG MAX. 250 kg

BOTTOM-HUNG MAX. 300 kg

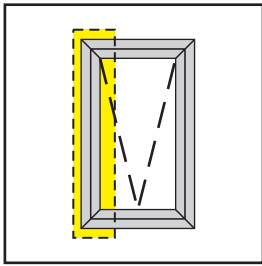

**OUTWARD
TOP-HUNG**

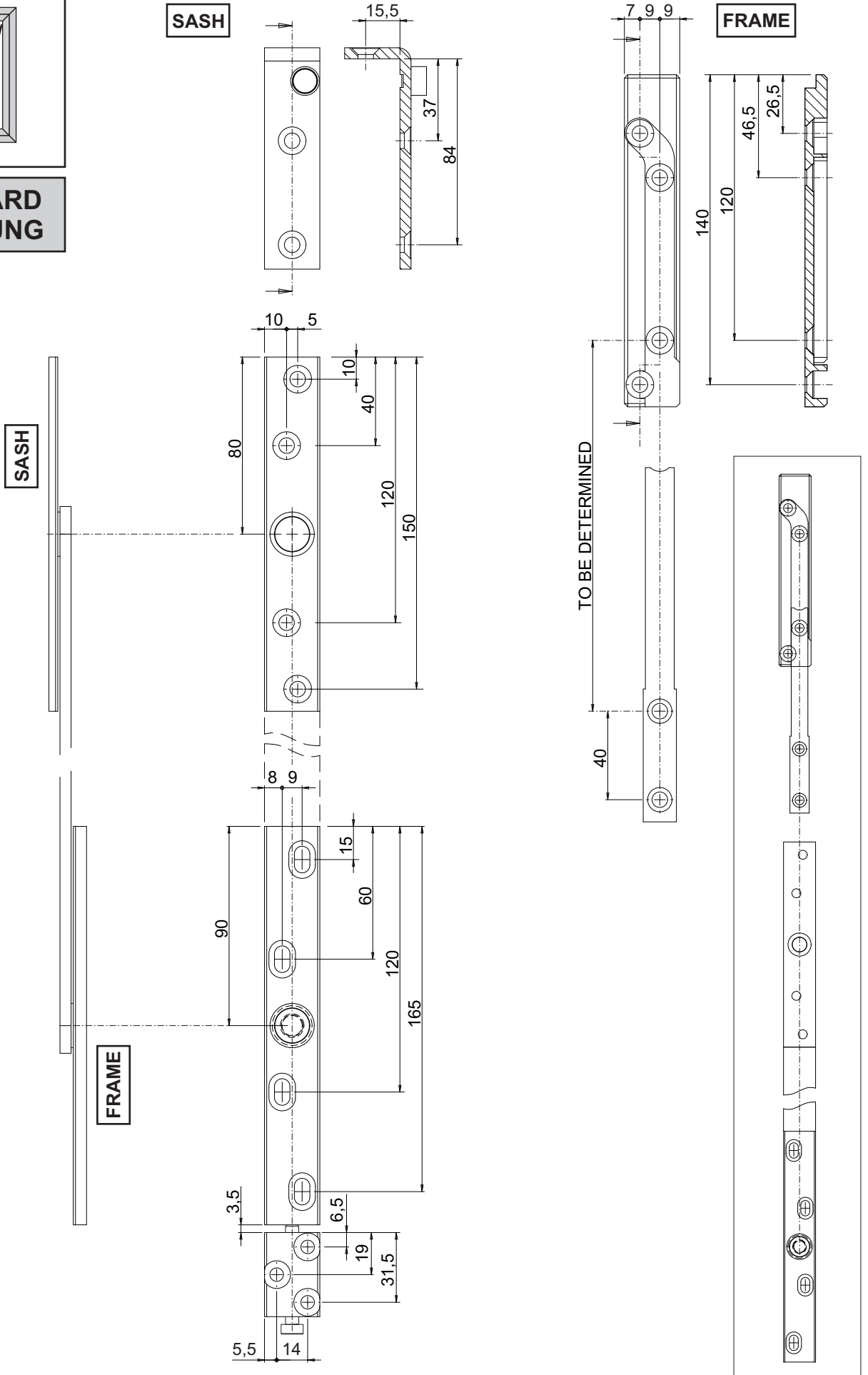

FRAME

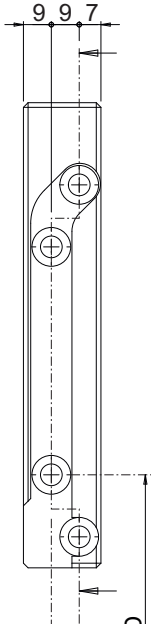
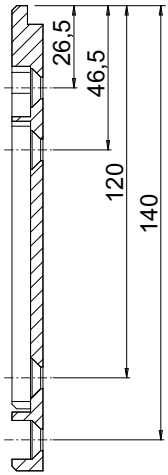

TO BE DETERMINED

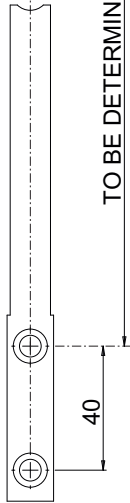

SASH

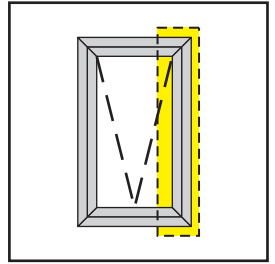
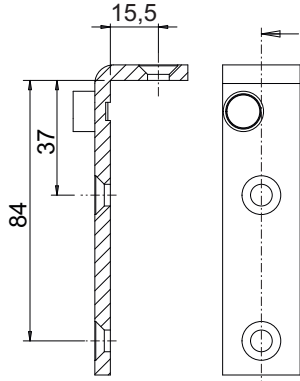

**OUTWARD
TOP-HUNG**

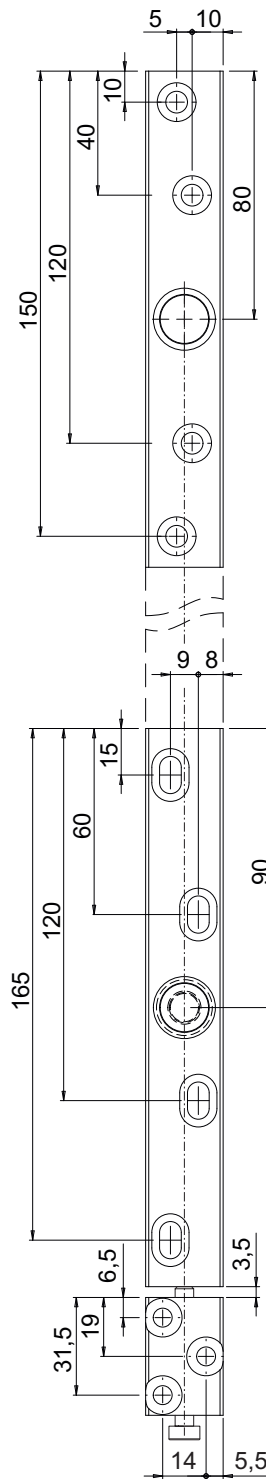
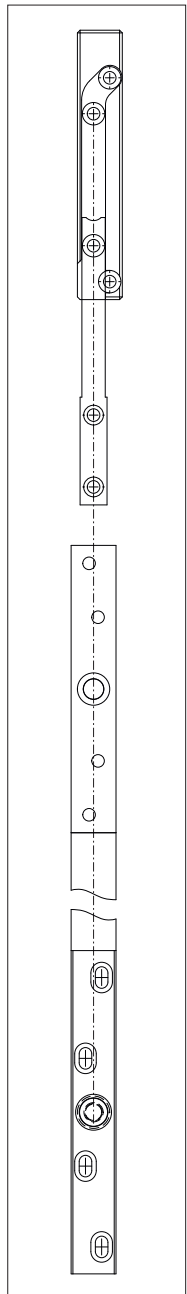

SASH

FRAME

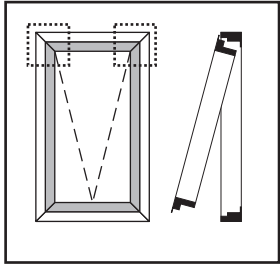

1 SASH

OUTWARD TOP-HUNG

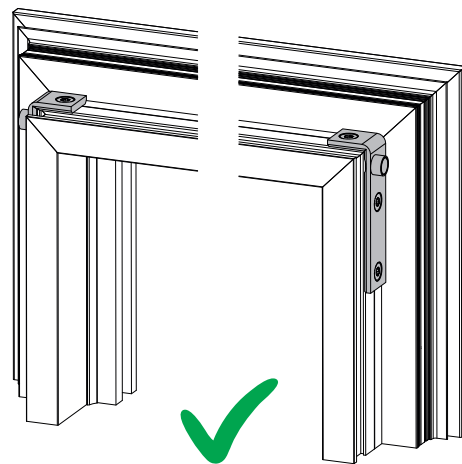
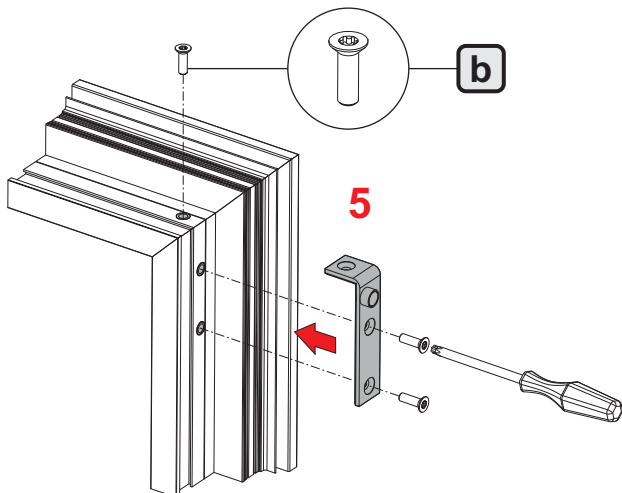
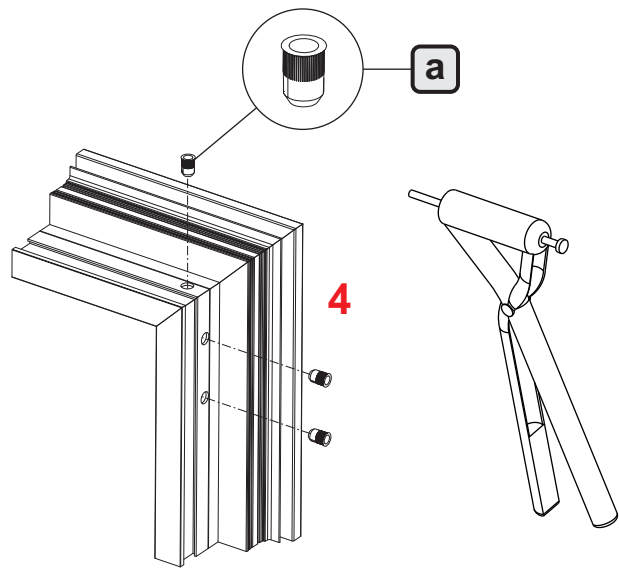
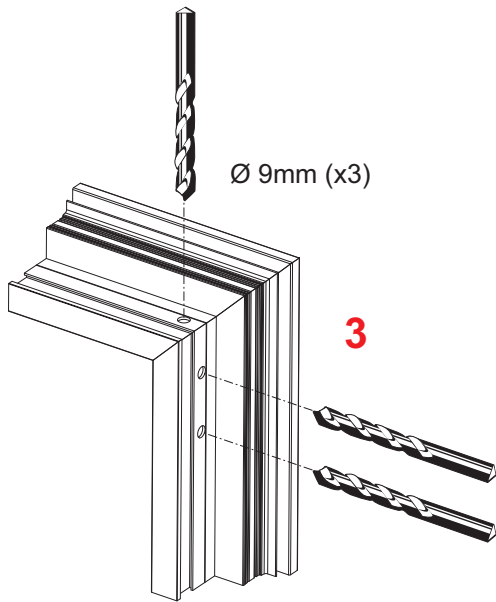
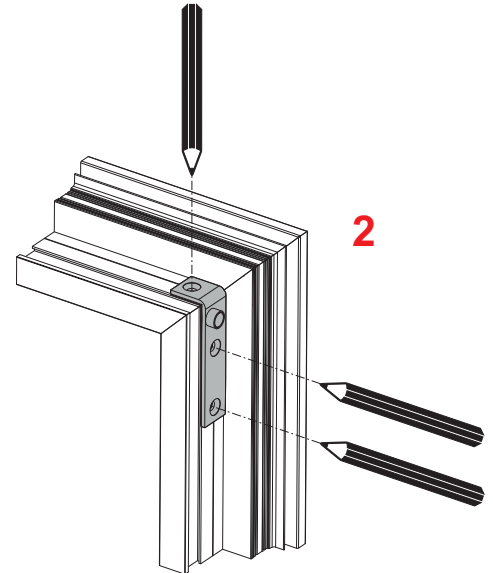
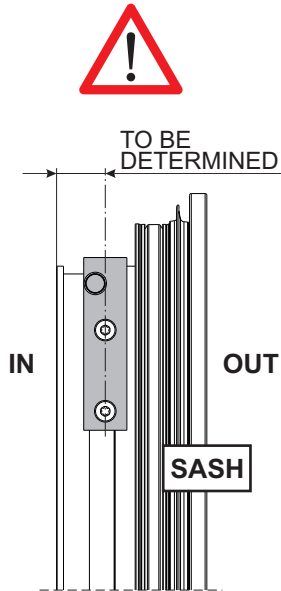
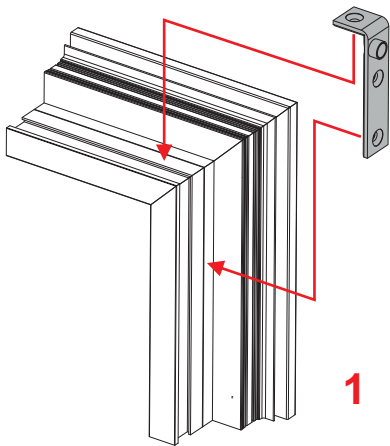

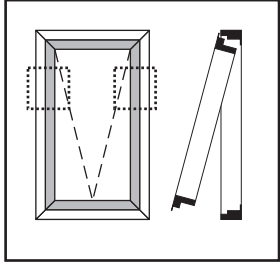

2 SASH

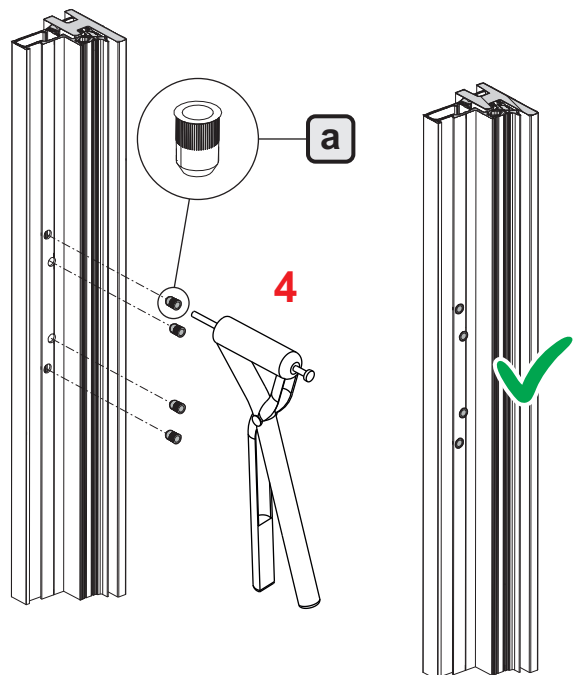
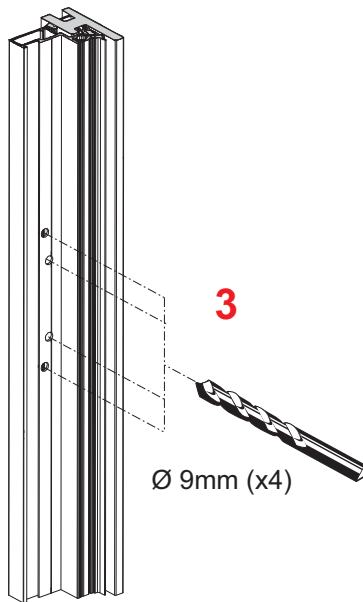
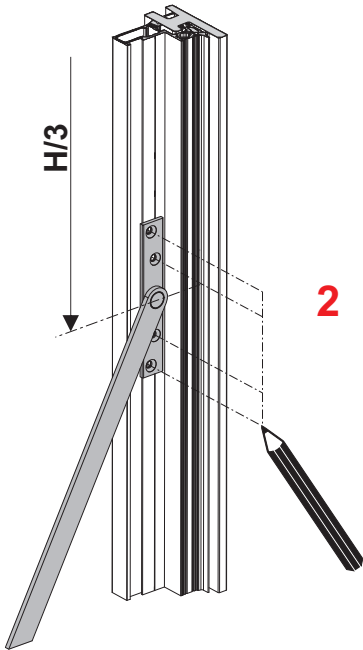
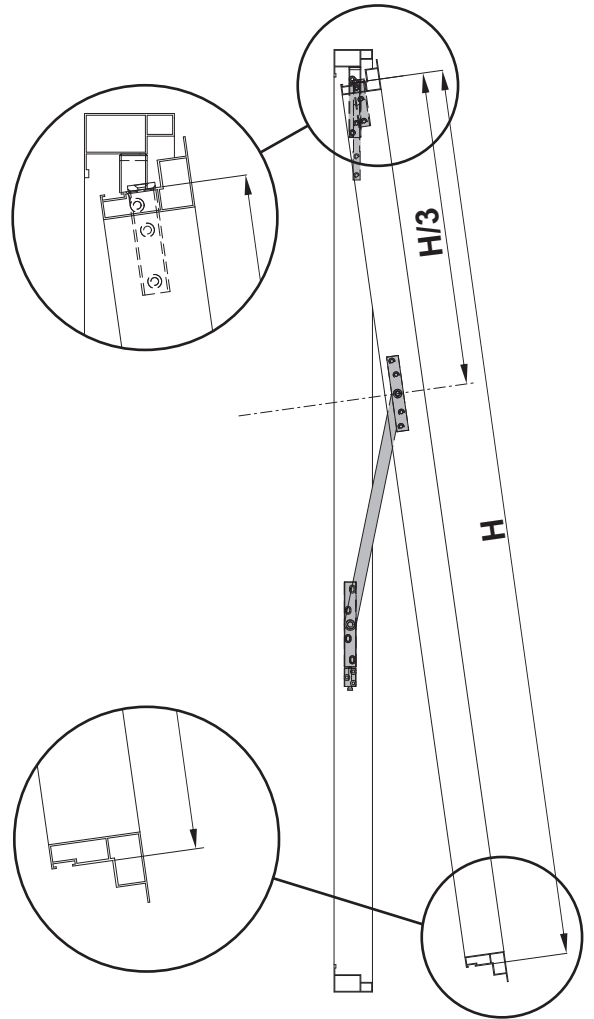
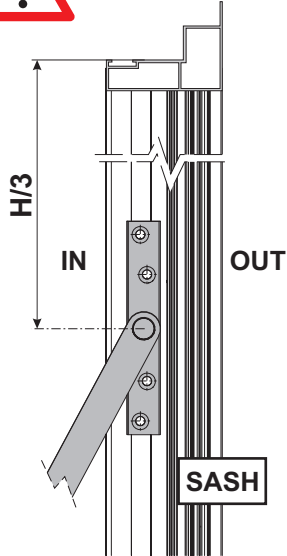
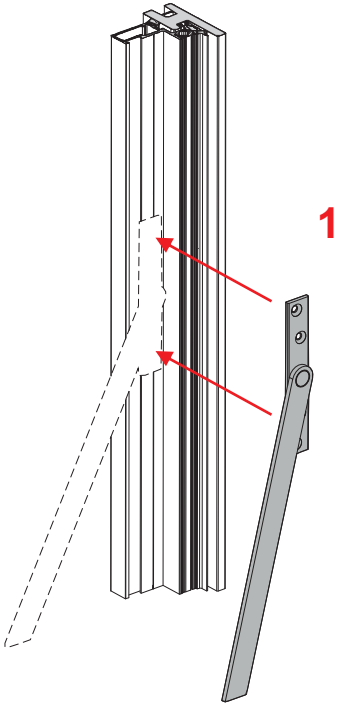

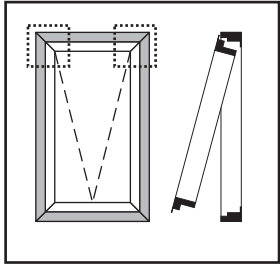

3 FRAME

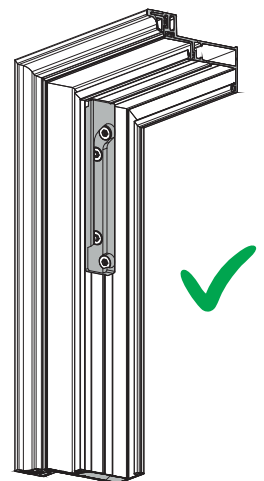
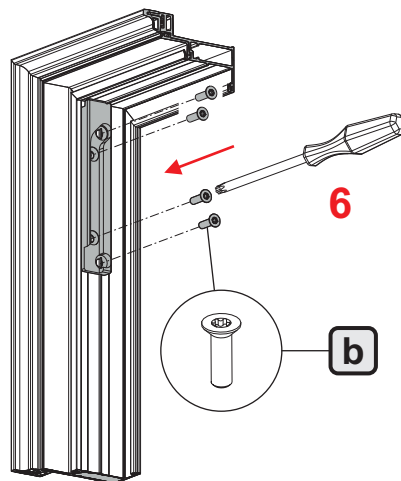
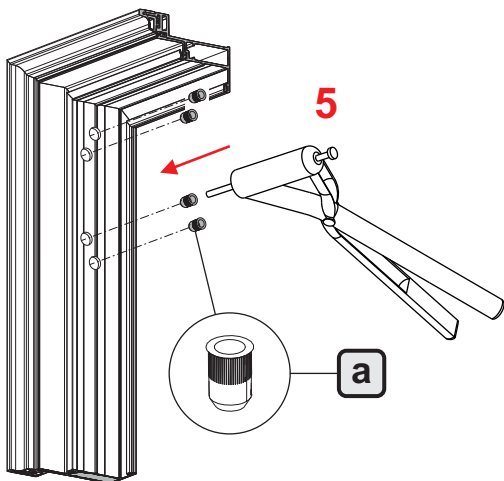
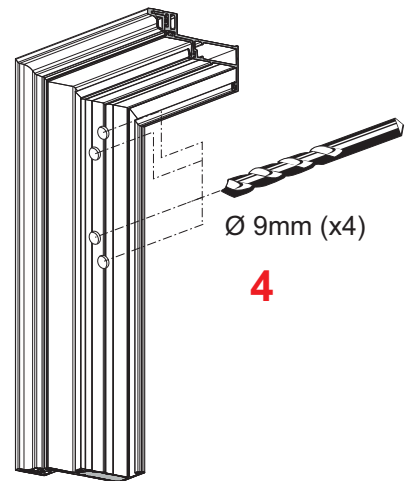
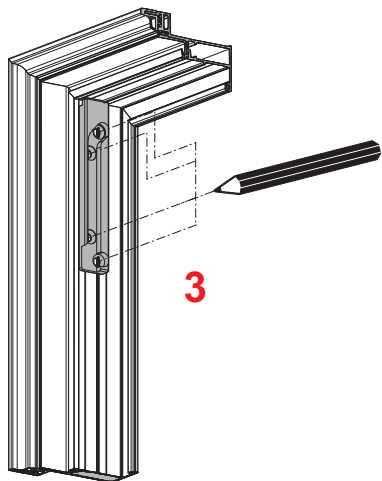
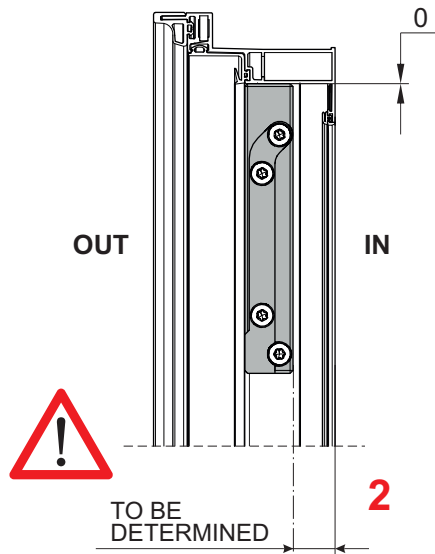
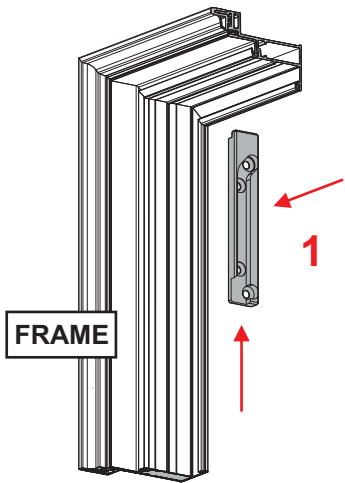

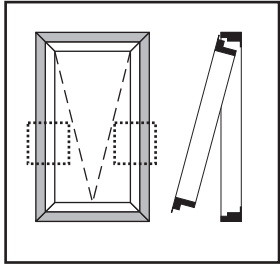

4 FRAME

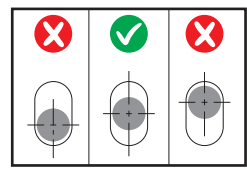
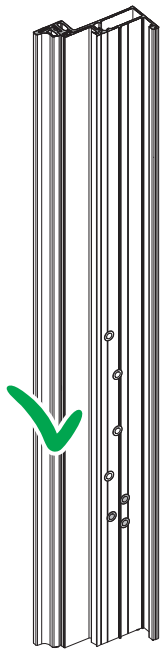
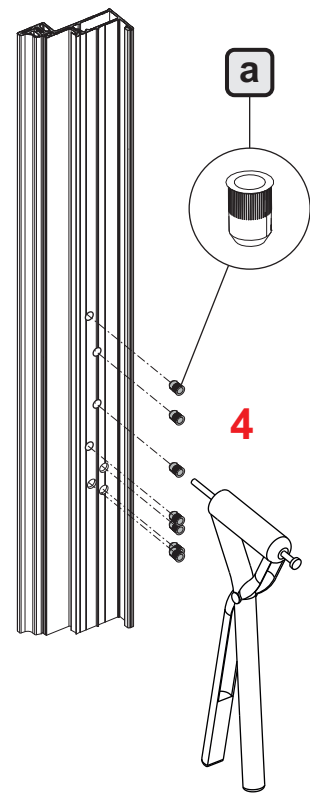
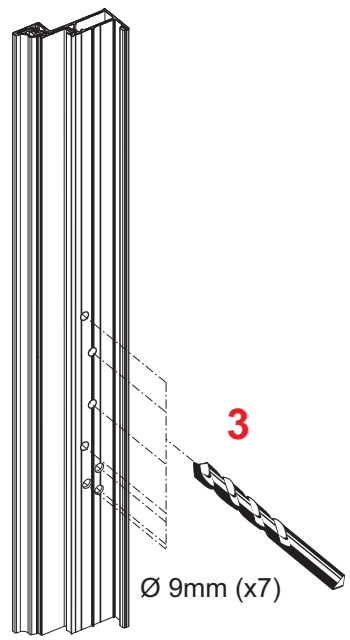
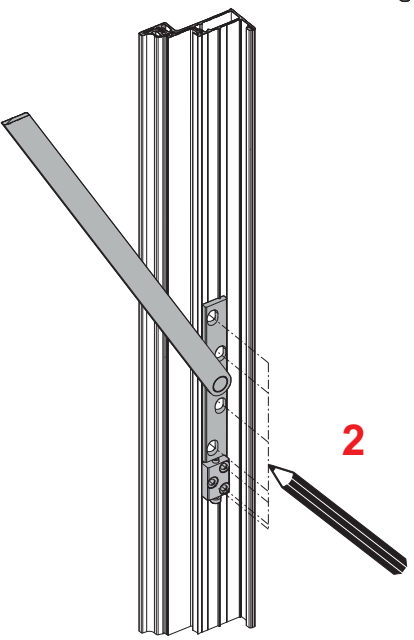
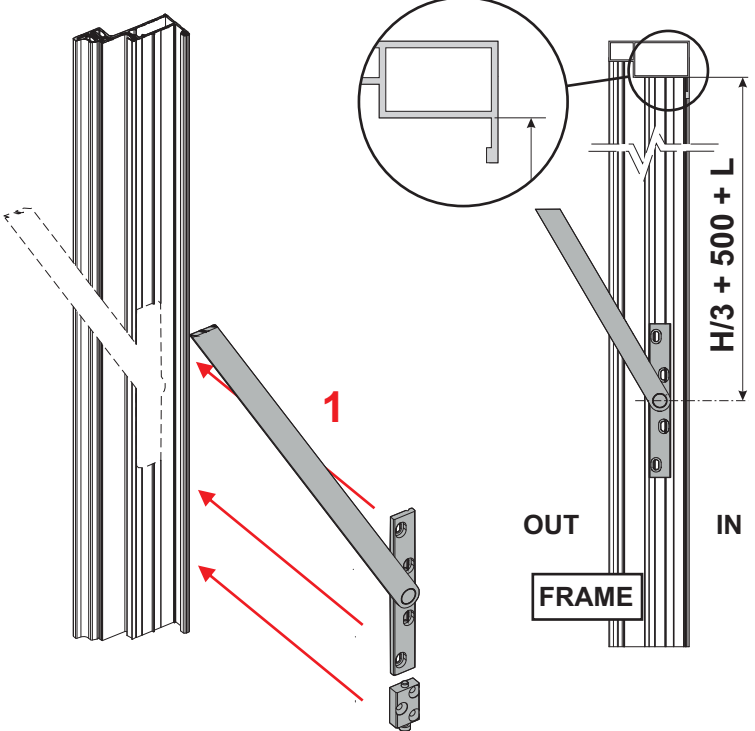
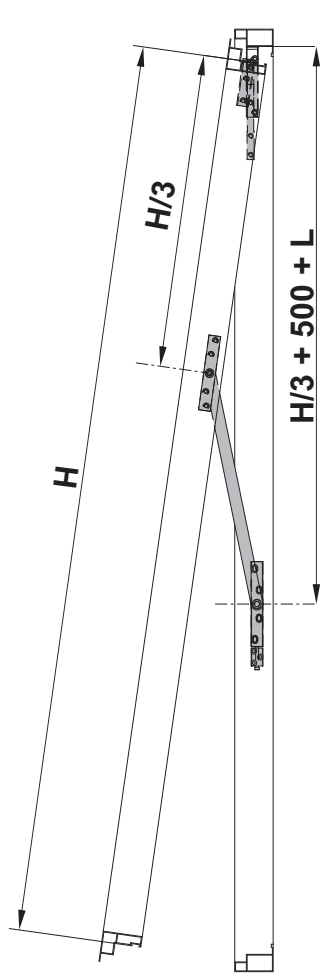
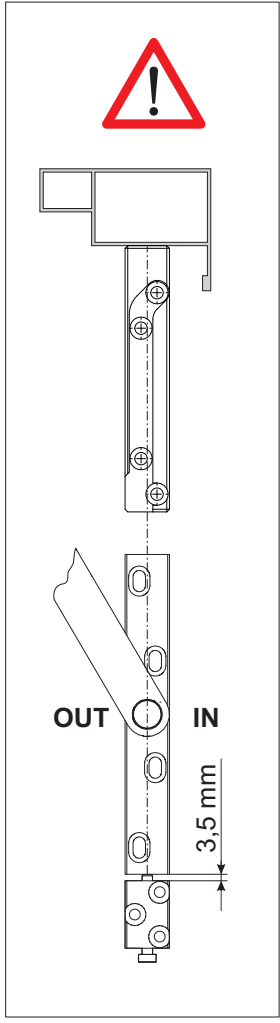
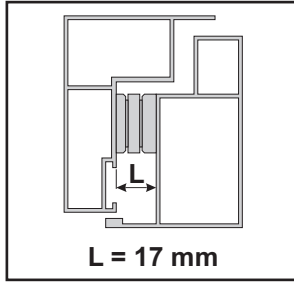

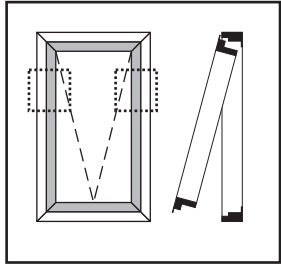

5 SASH

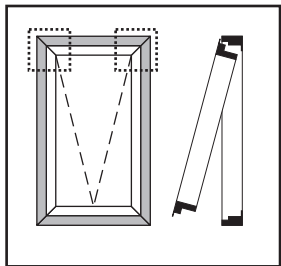
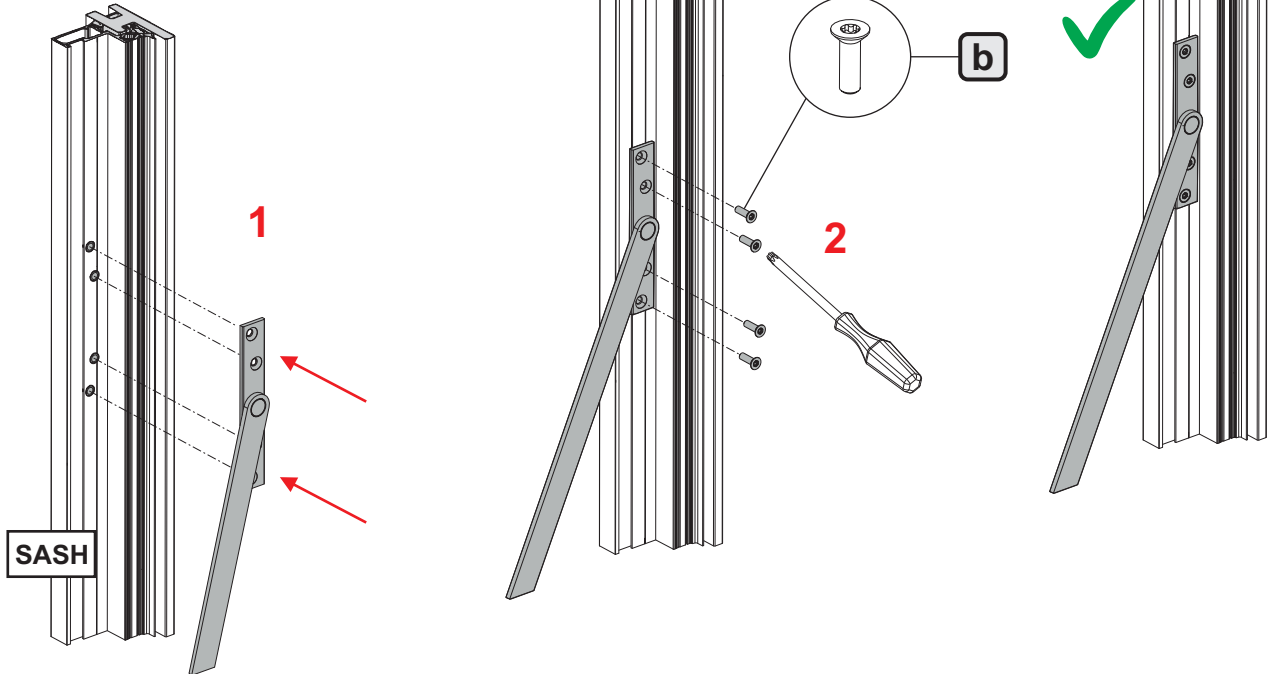

6 FRAME

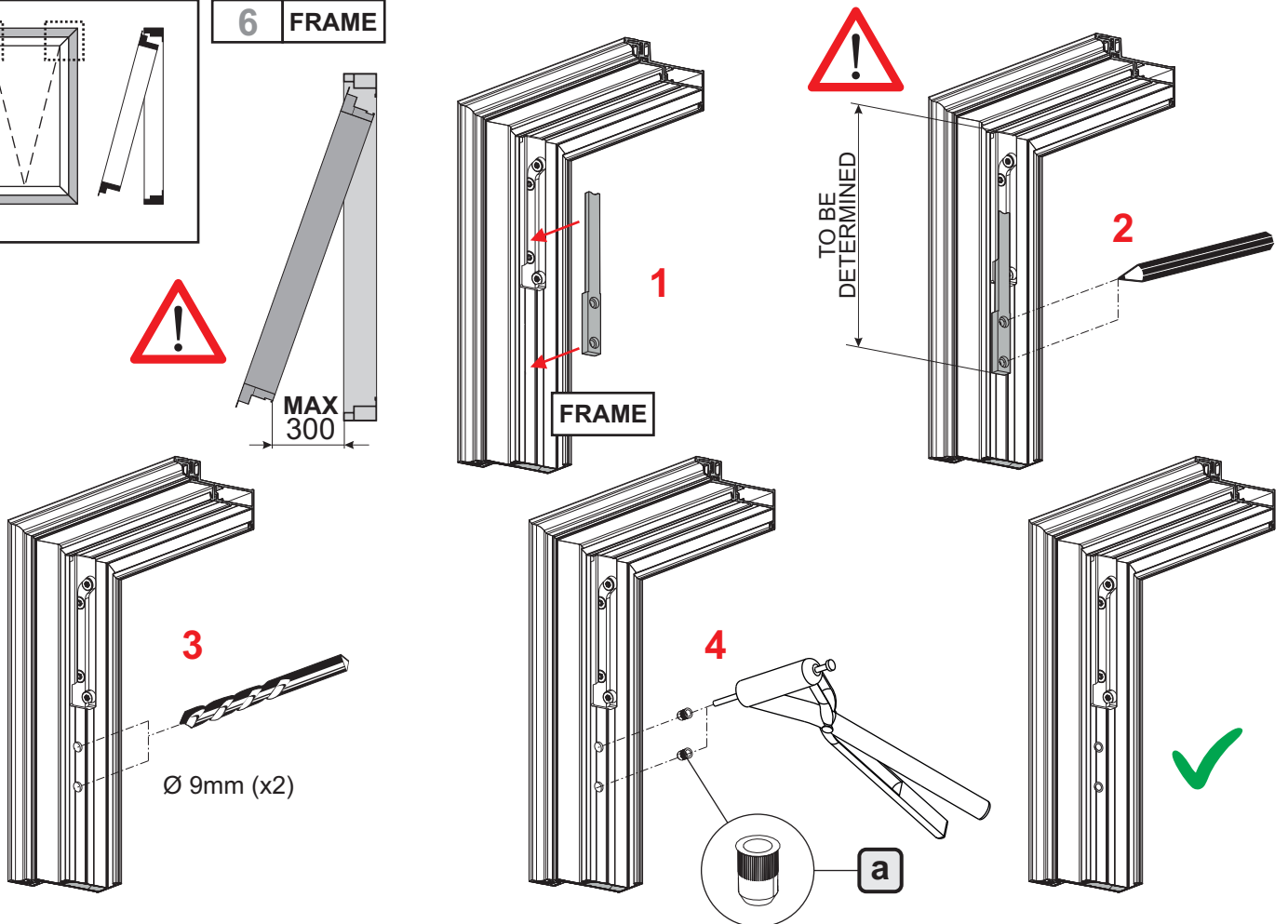

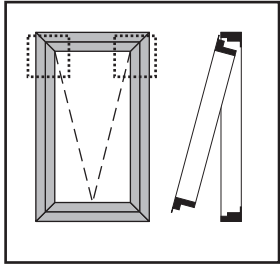

7

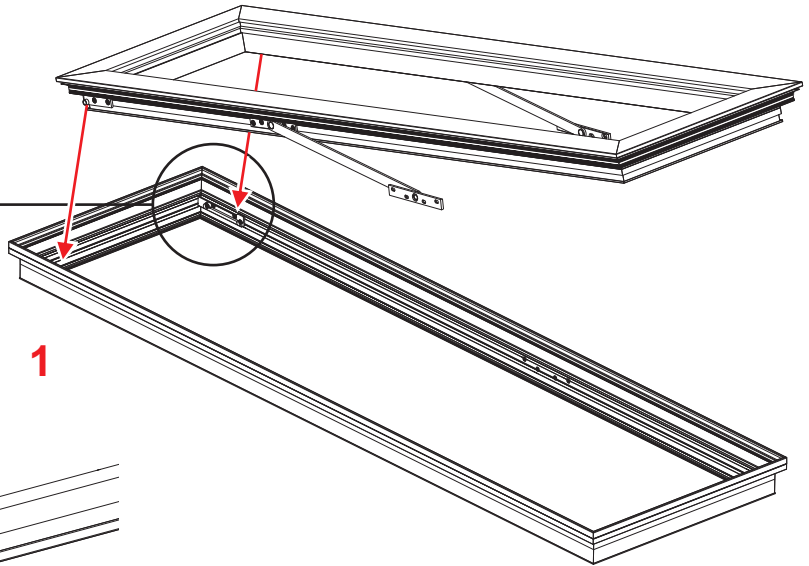

1

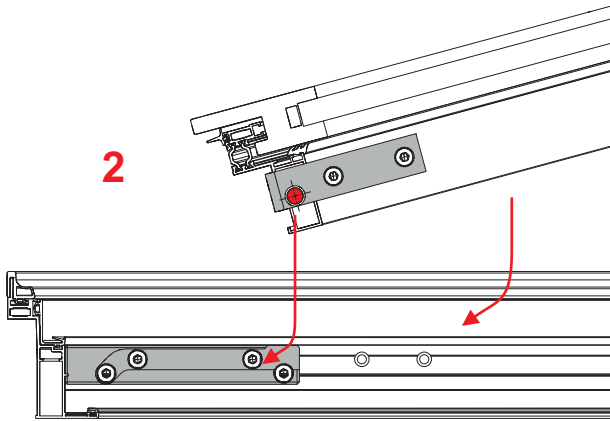

2

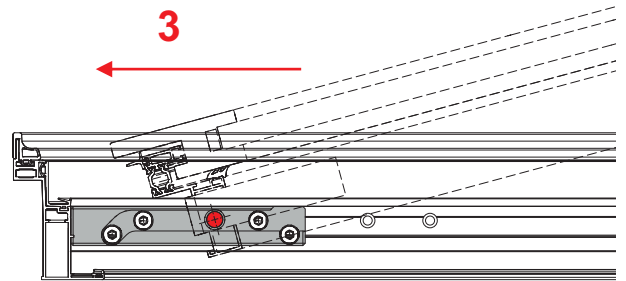

3

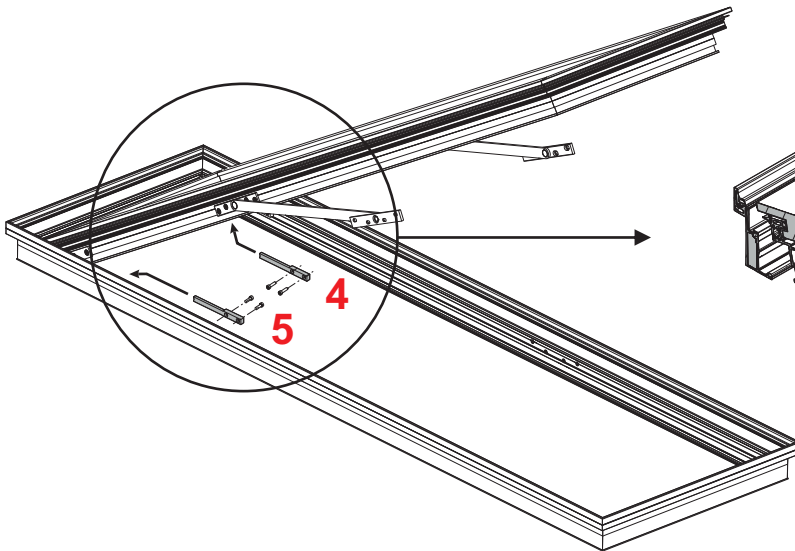

4

5

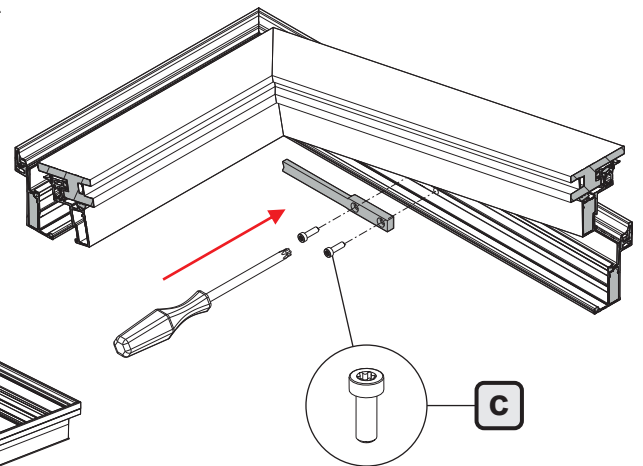

C

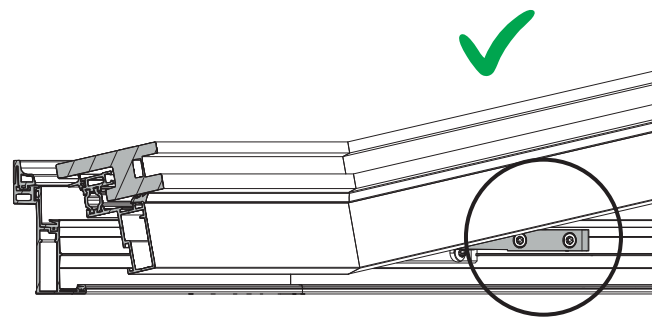
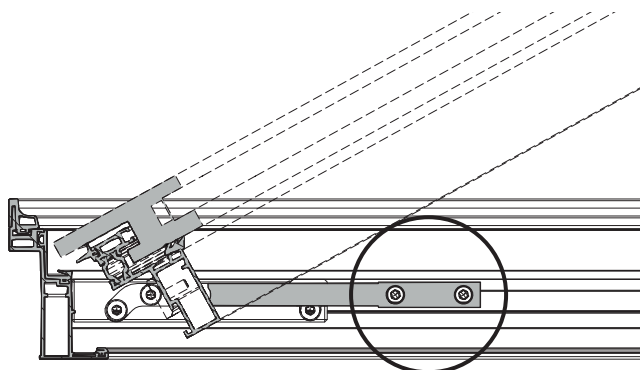

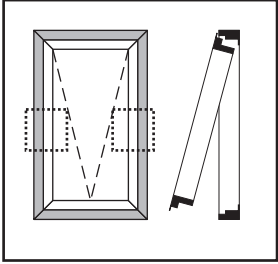

8

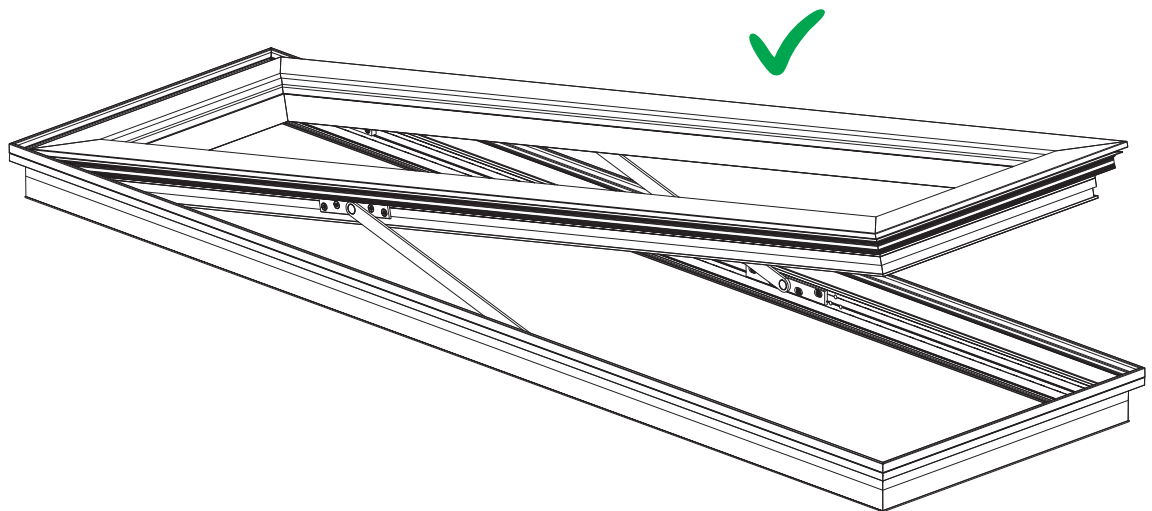
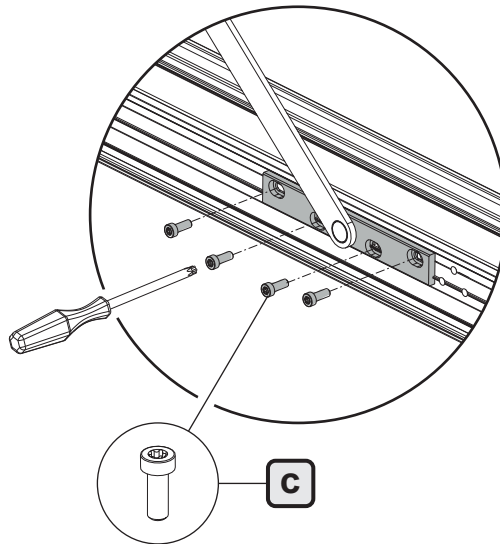
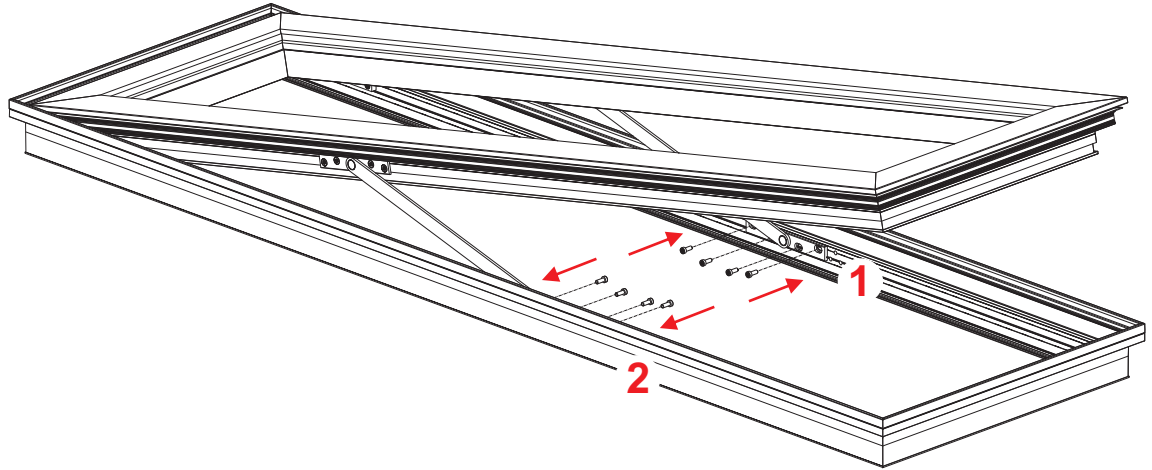

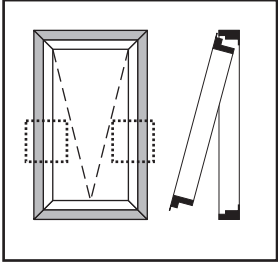

9

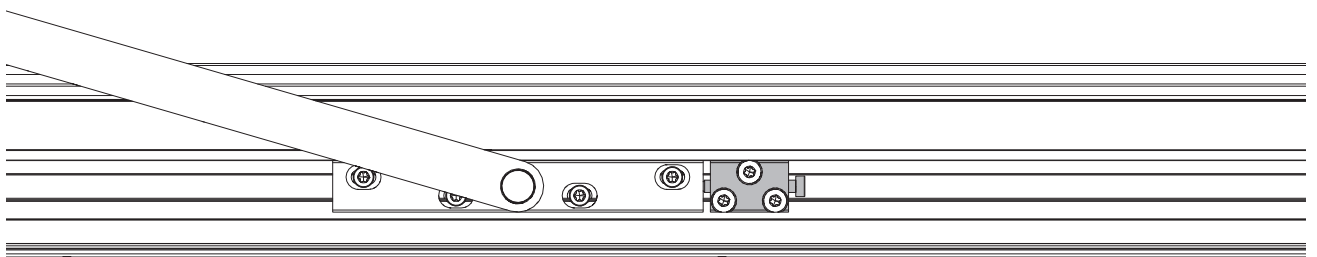
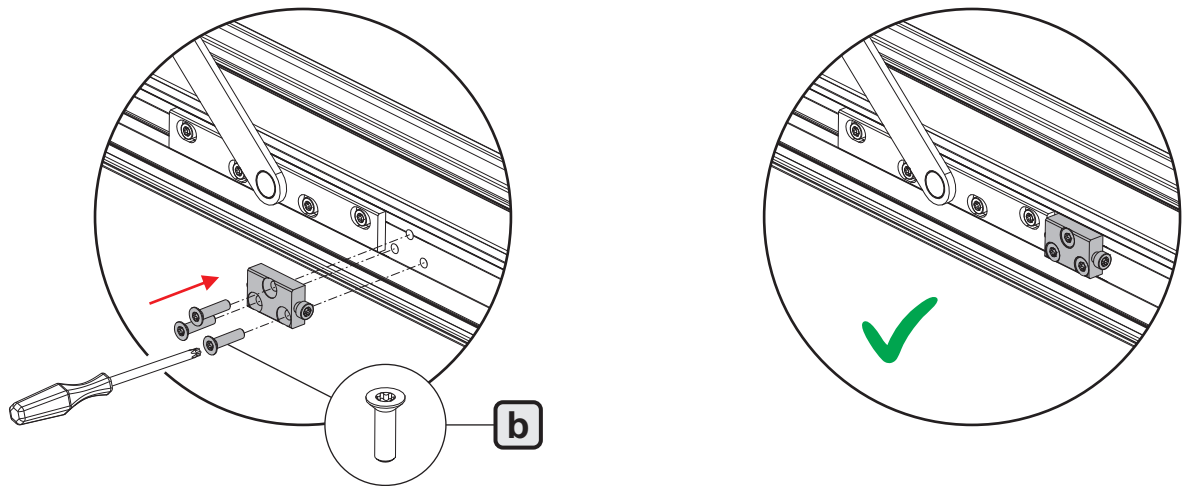
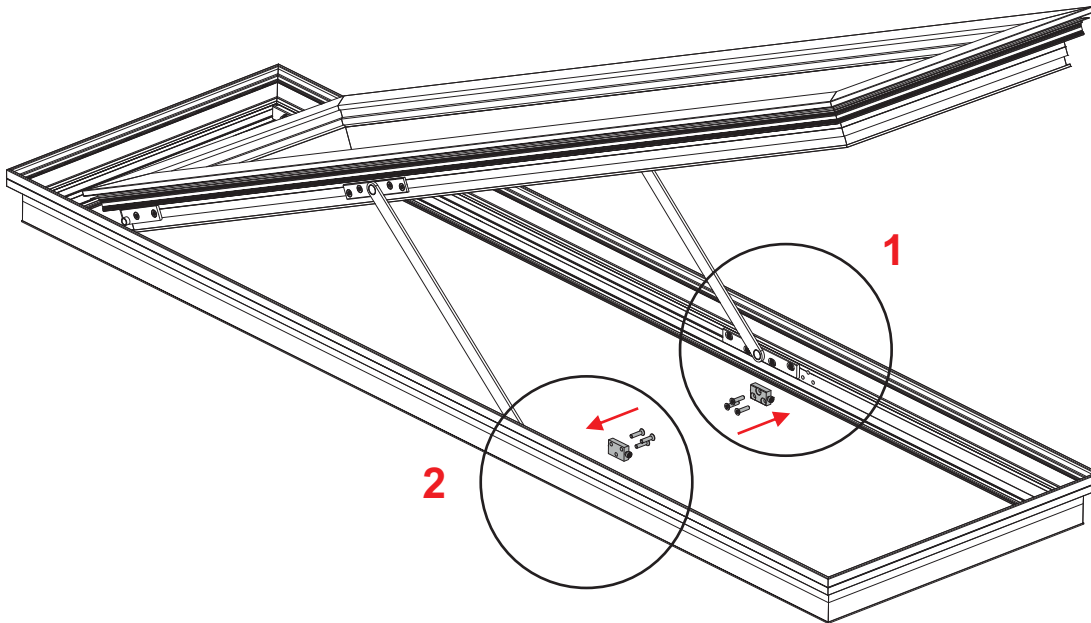

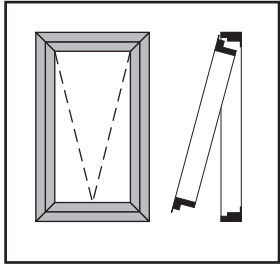

10

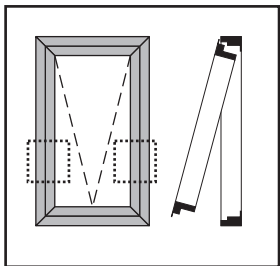
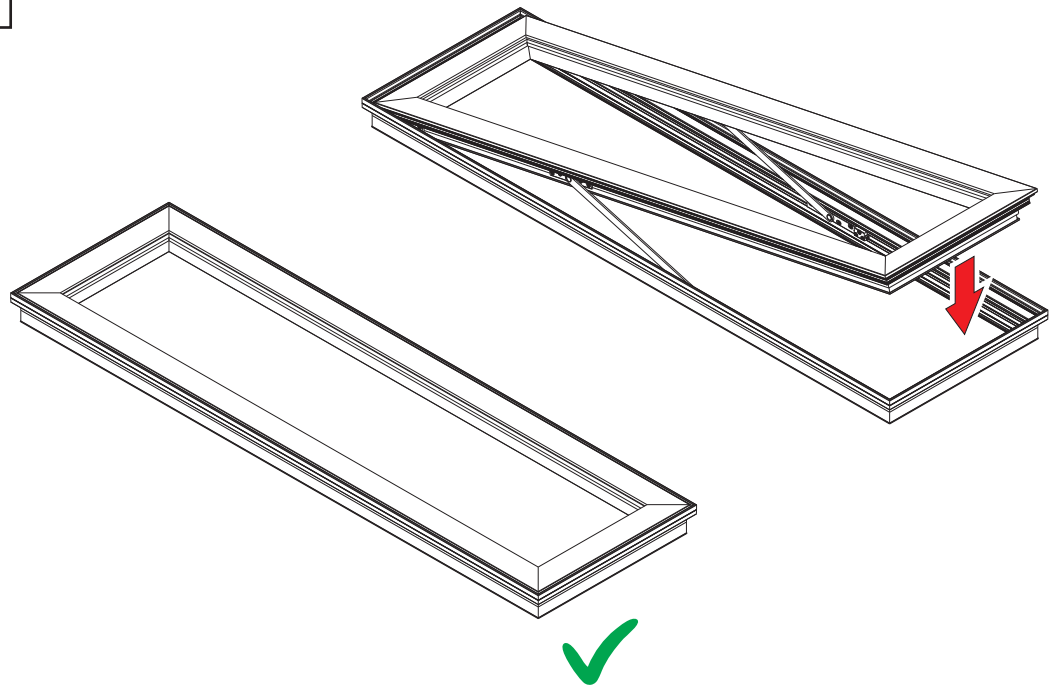

11 FRAME

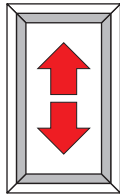

Regolazioni - Adjustments - Réglages -
Regulaciones - Einstellungen - Регулировки

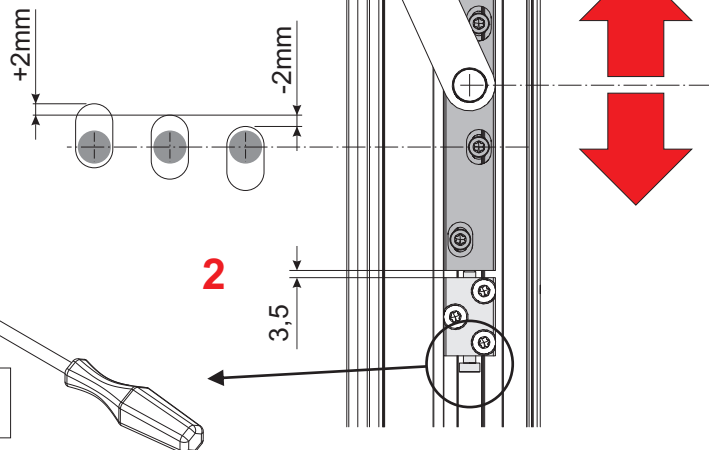
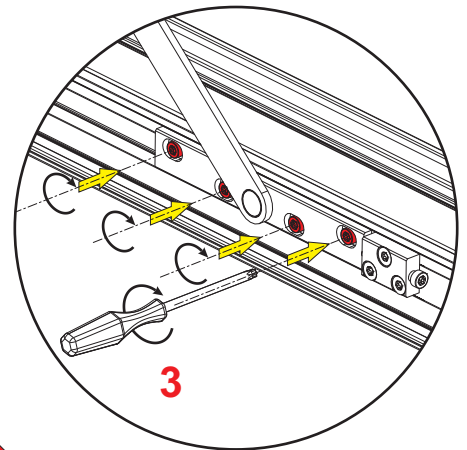
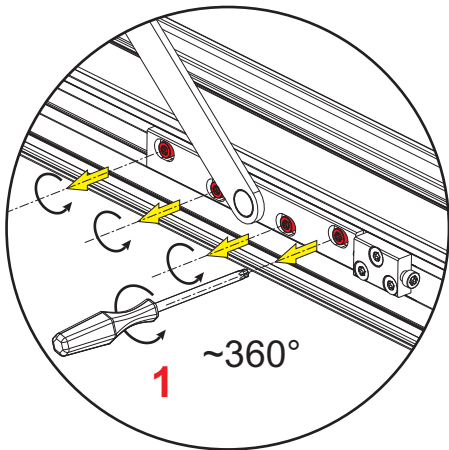

TORX T30

**OUTWARD
BOTTOM-HUNG**

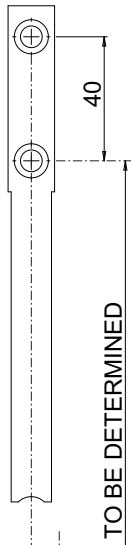
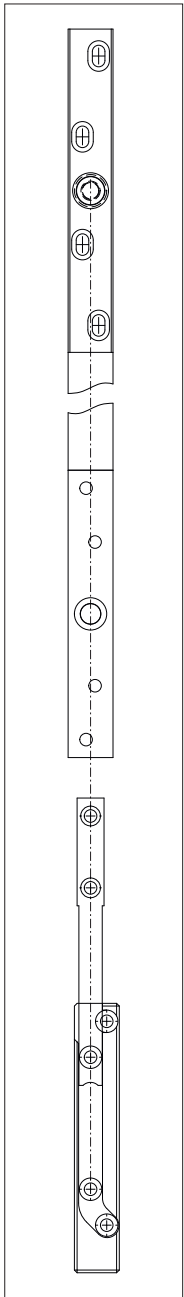
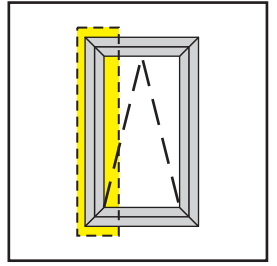

TO BE DETERMINED

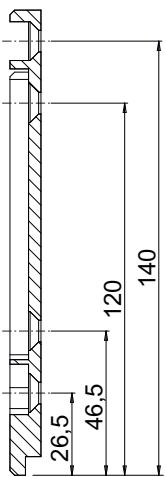

FRAME

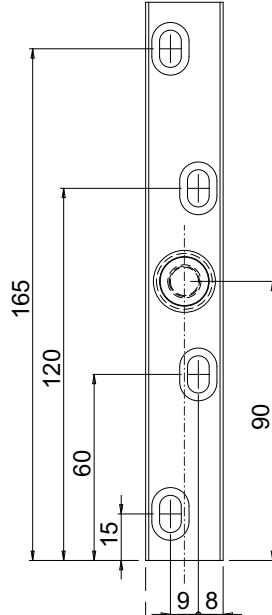
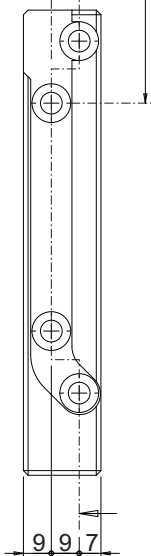

FRAME

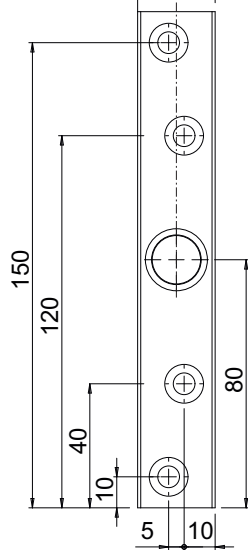

SASH

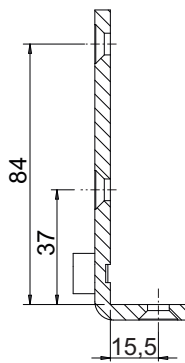

SASH

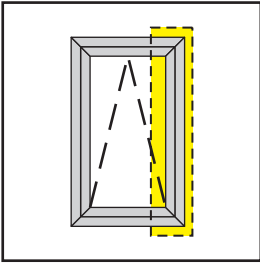

**OUTWARD
BOTTOM-HUNG**

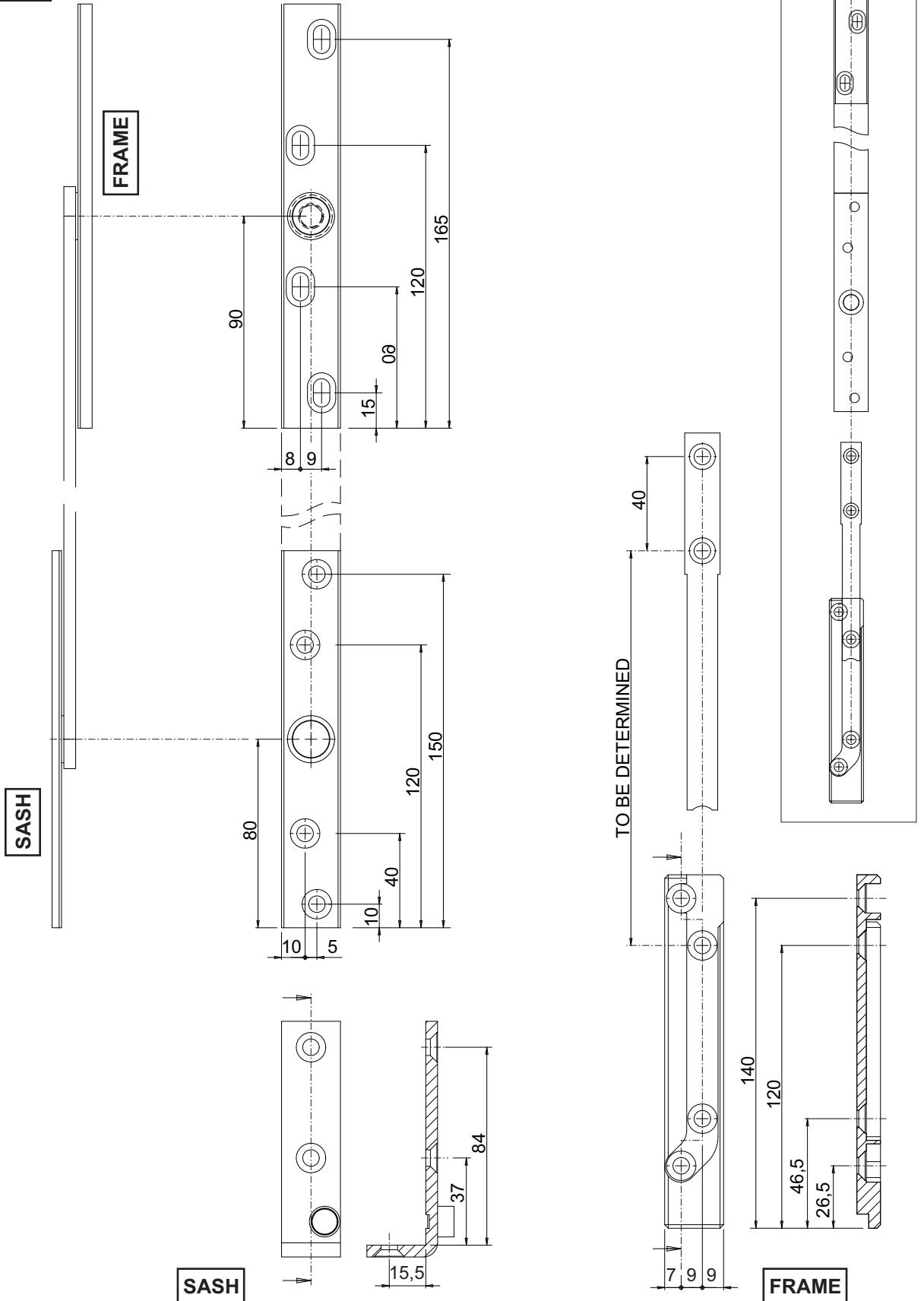

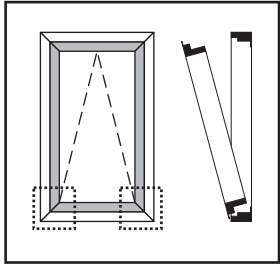

1 SASH

OUTWARD BOTTOM-HUNG

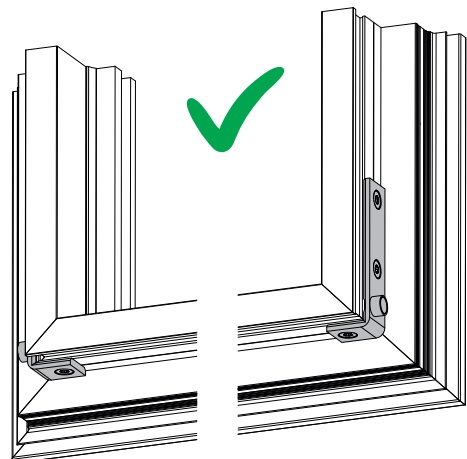
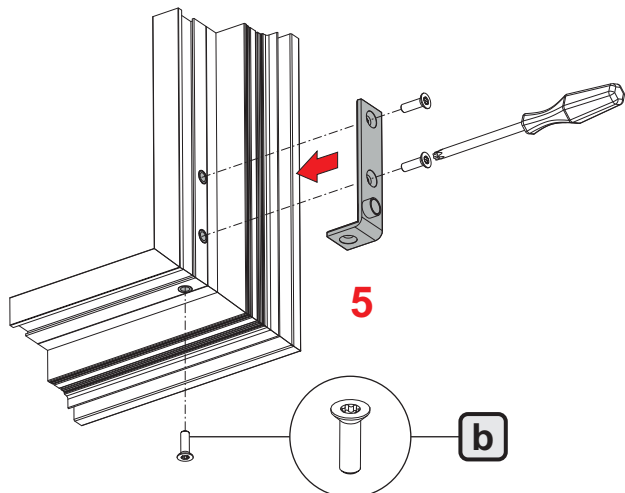
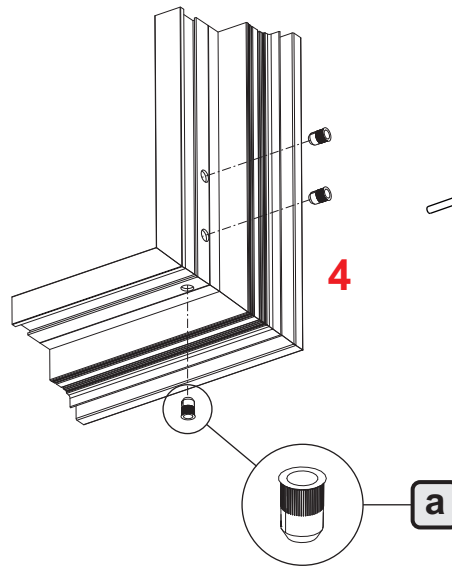
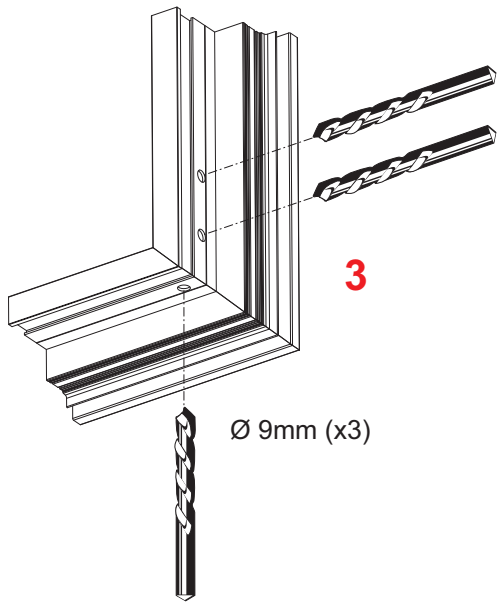
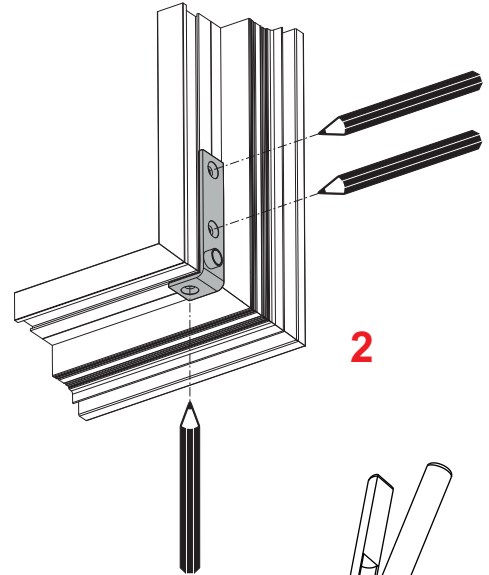
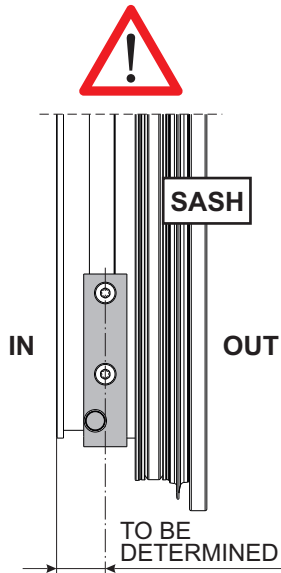
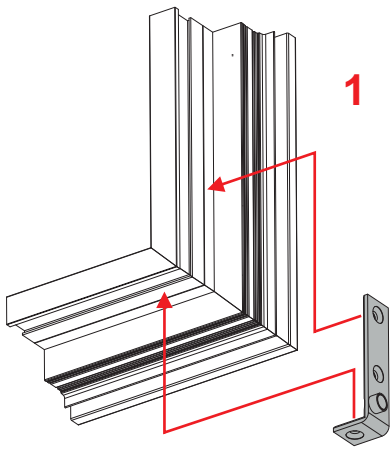

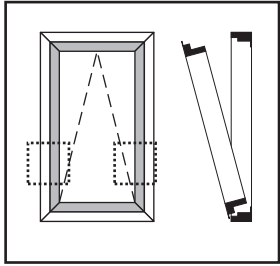

2 SASH

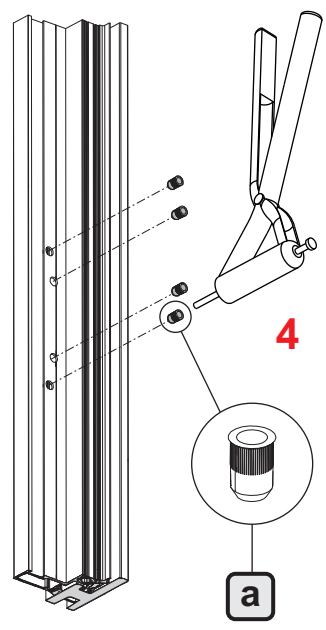
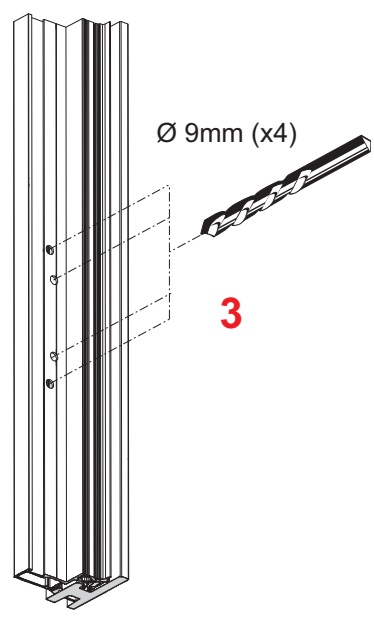
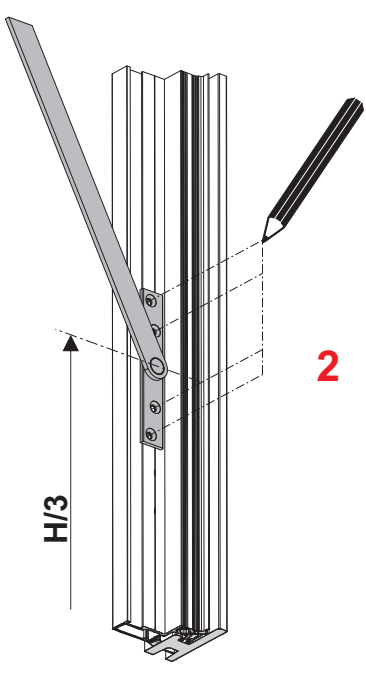
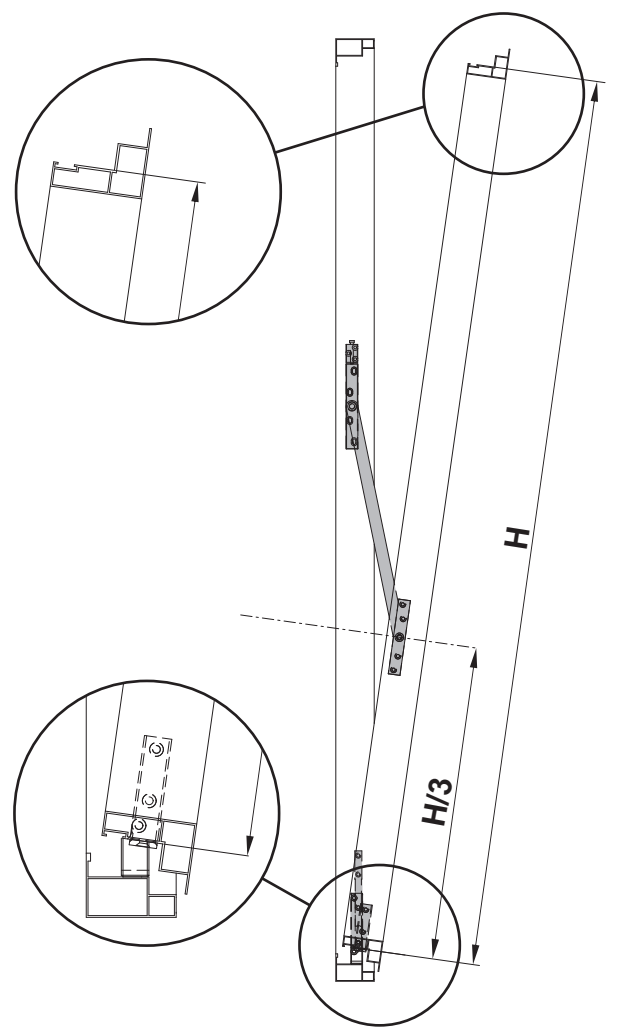
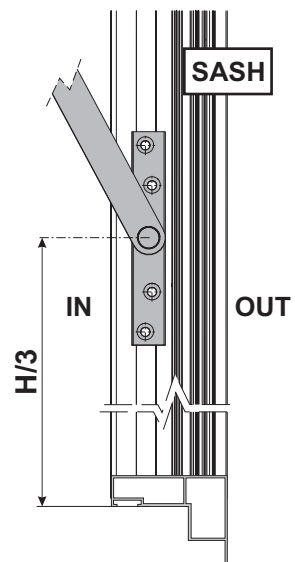
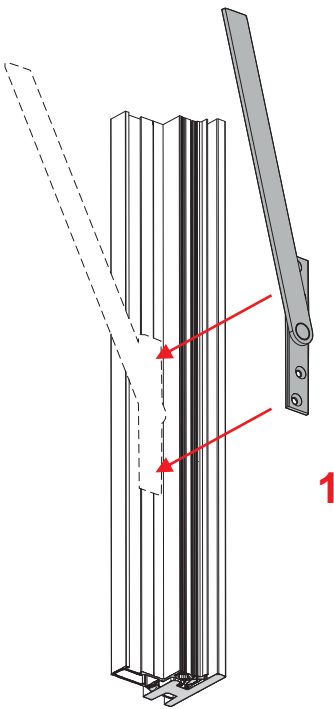

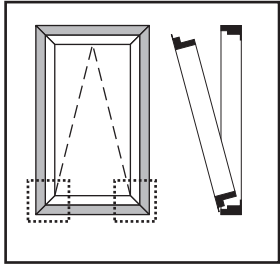

3 FRAME

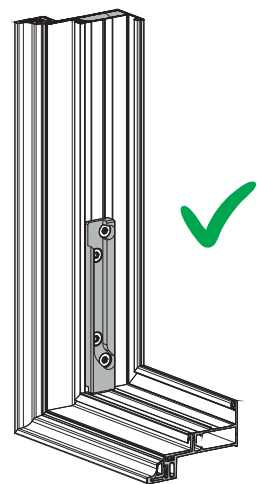
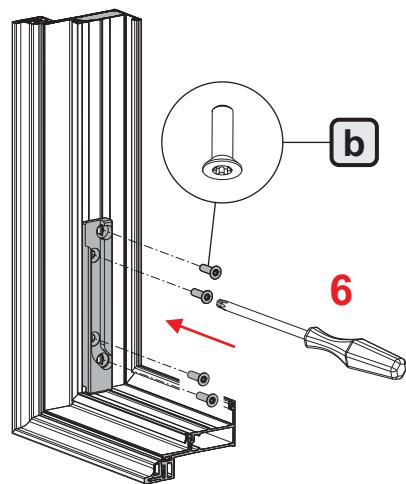
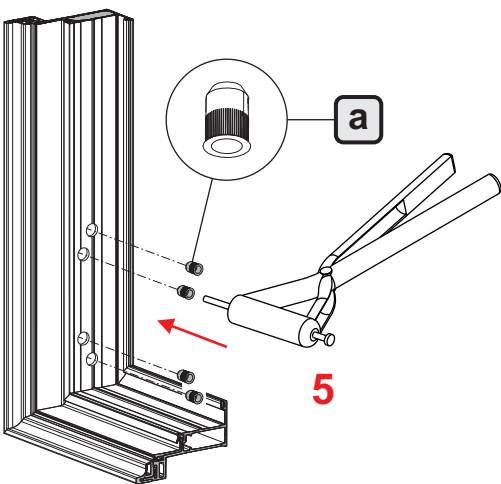
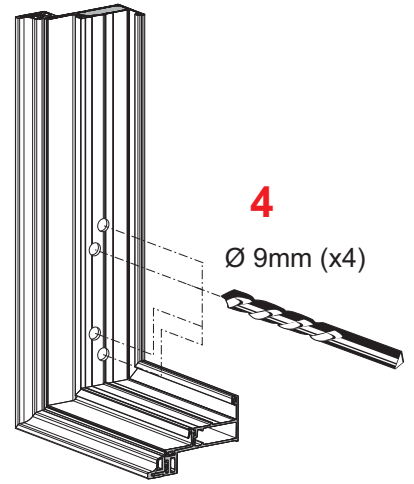
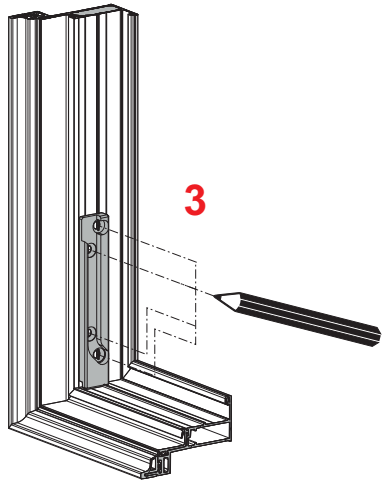
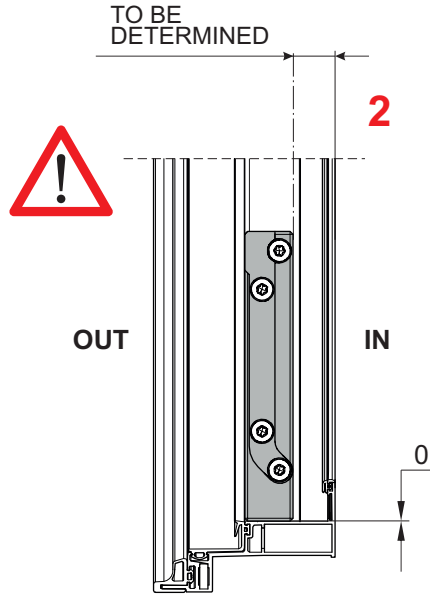
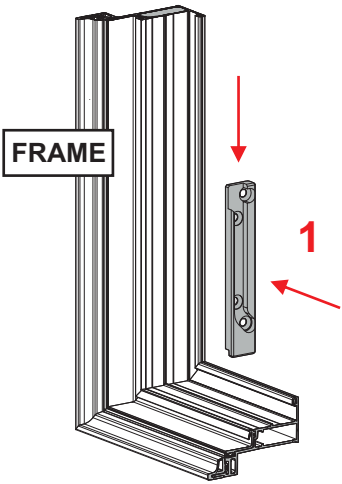

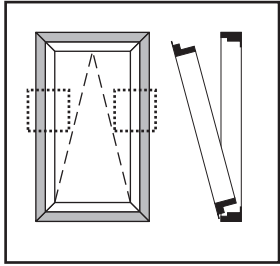

4 FRAME

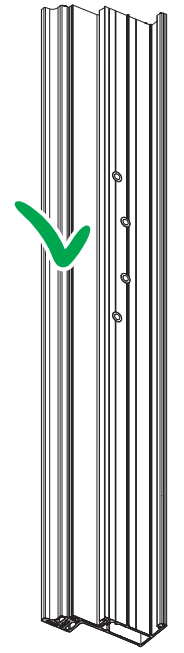
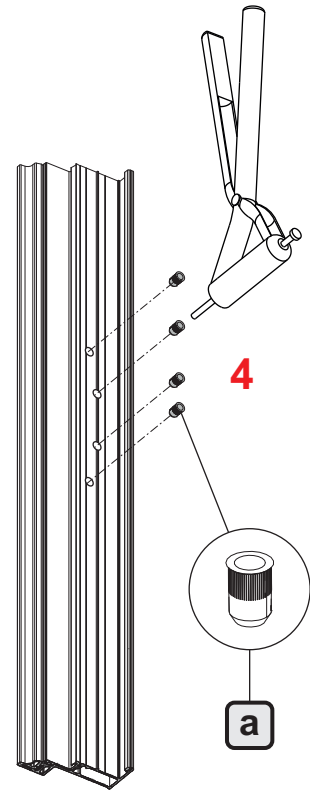
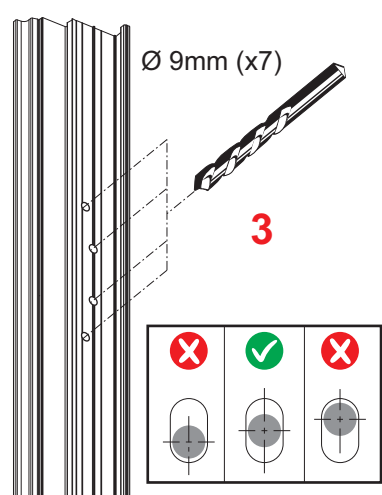
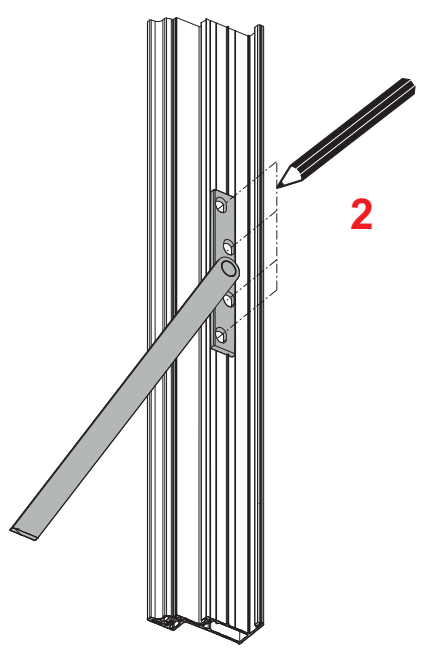
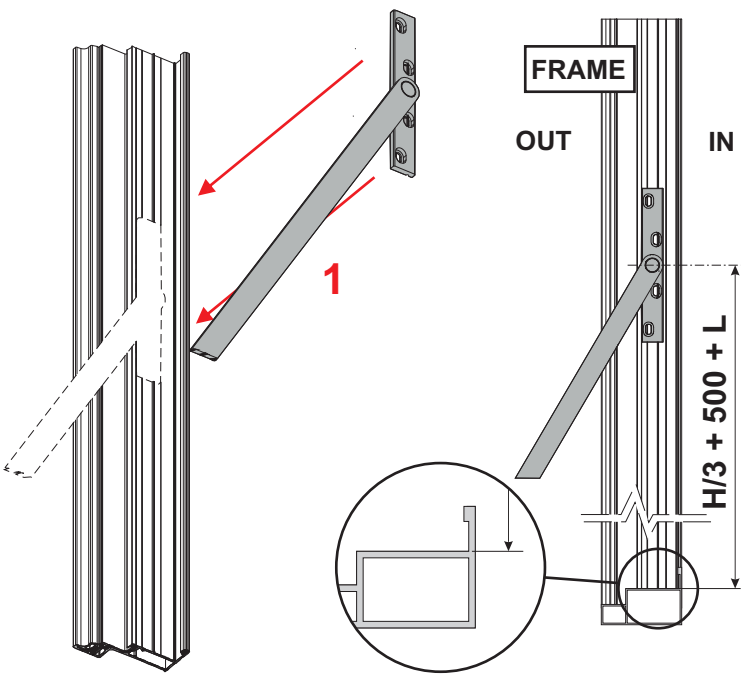
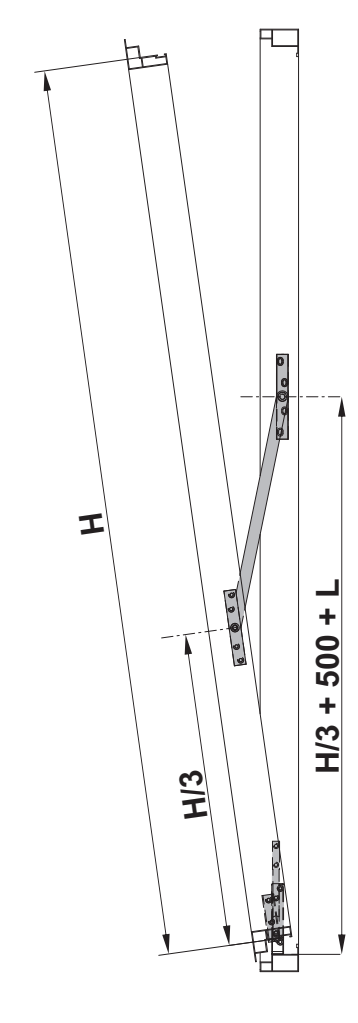
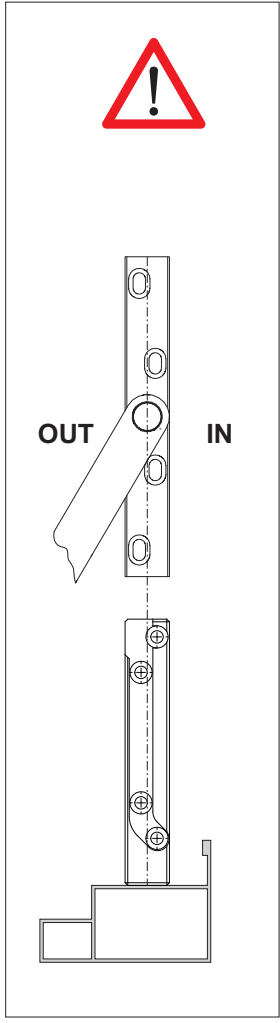
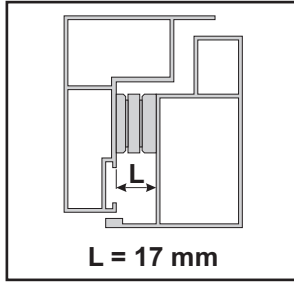

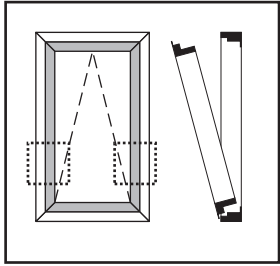

5 SASH

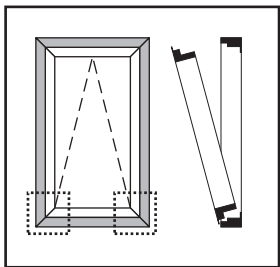
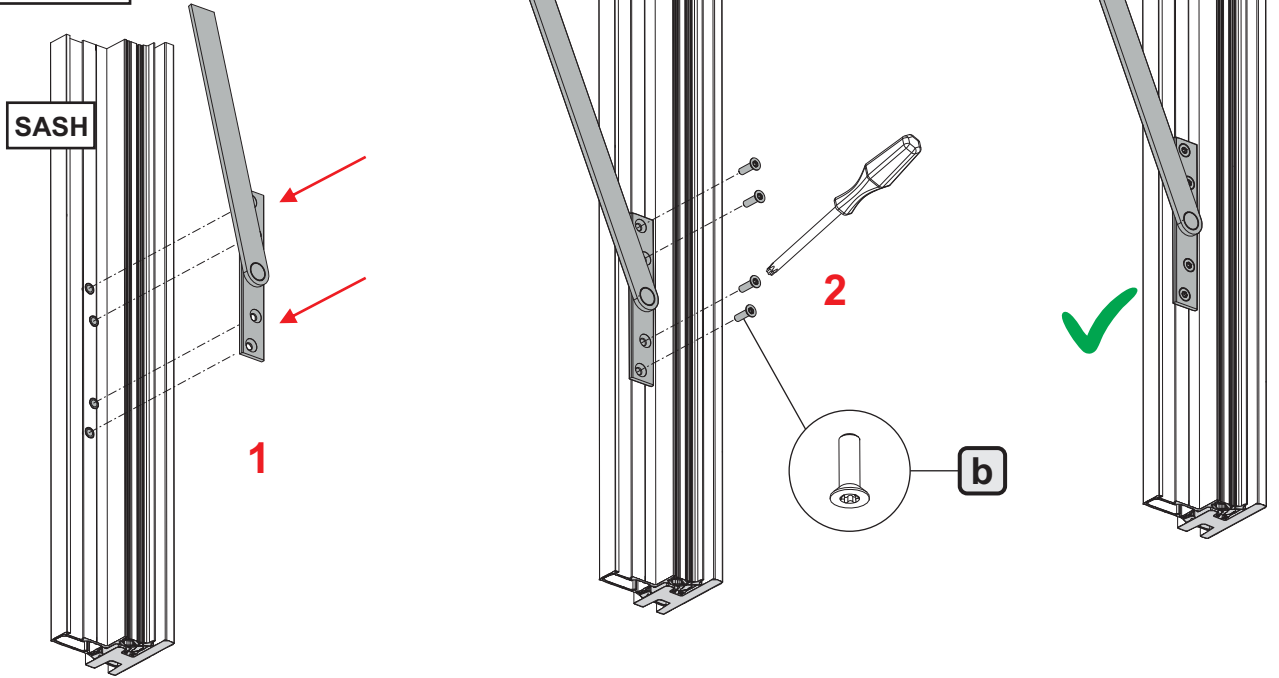

6 FRAME

MAX
300

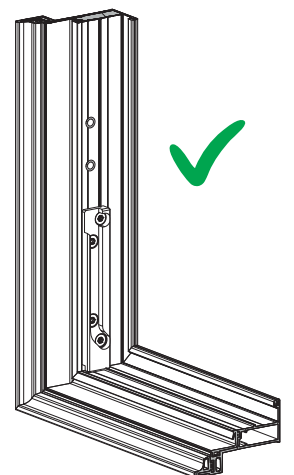
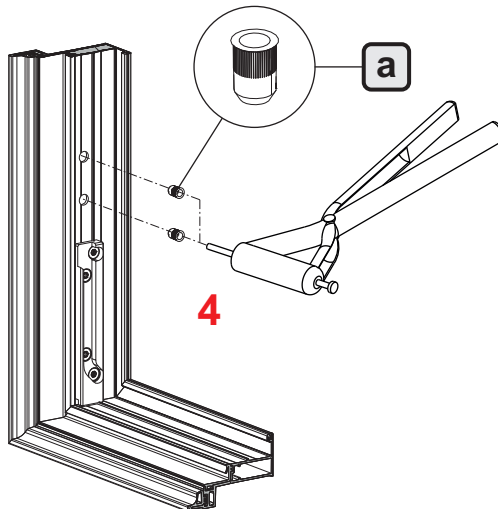
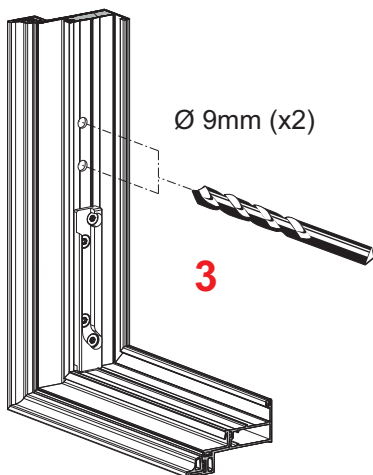
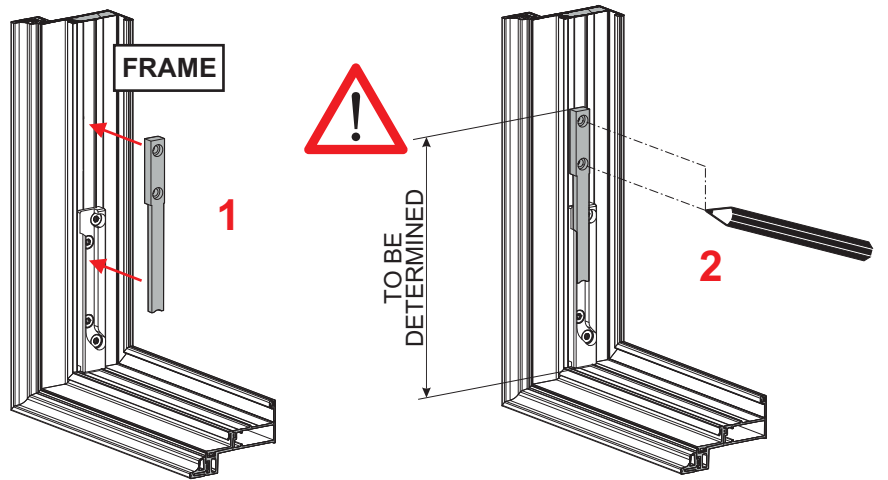

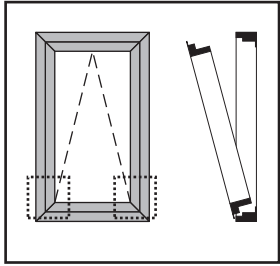

7

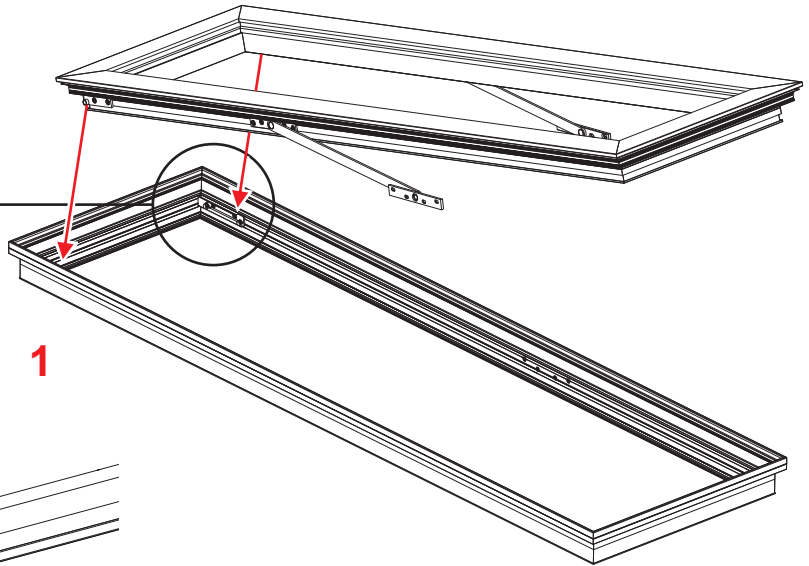

1

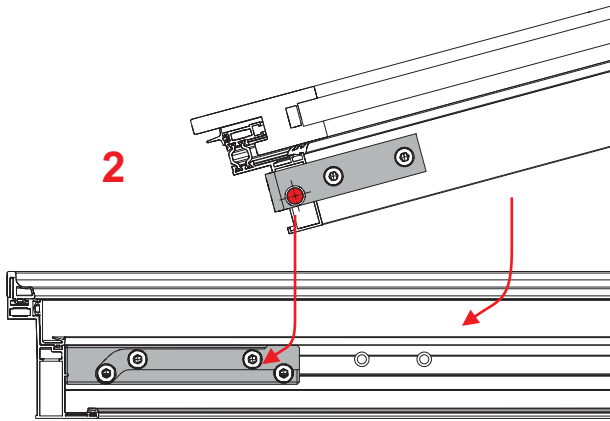

2

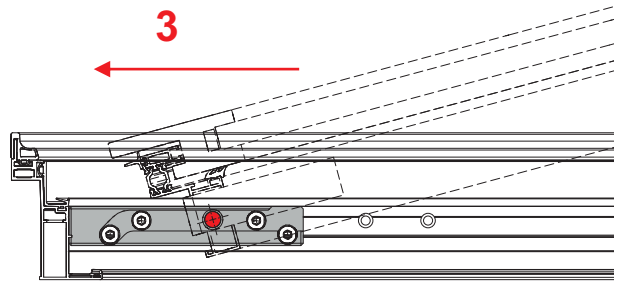

3

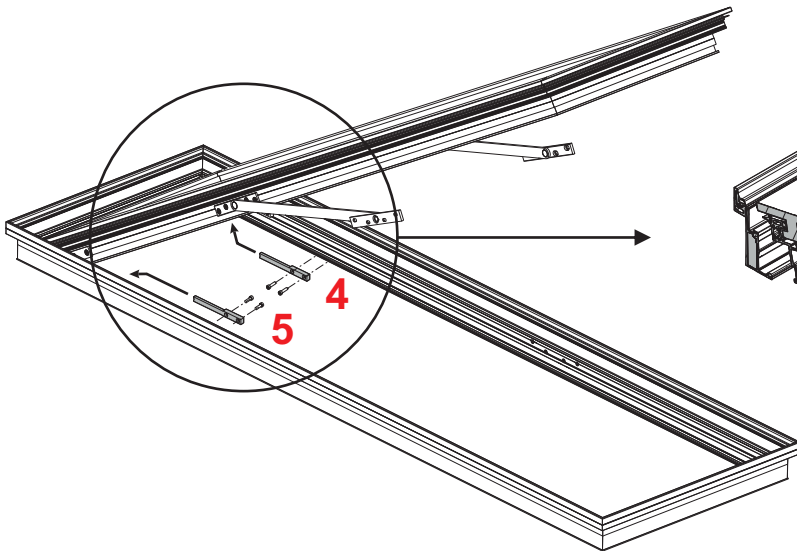

4

5

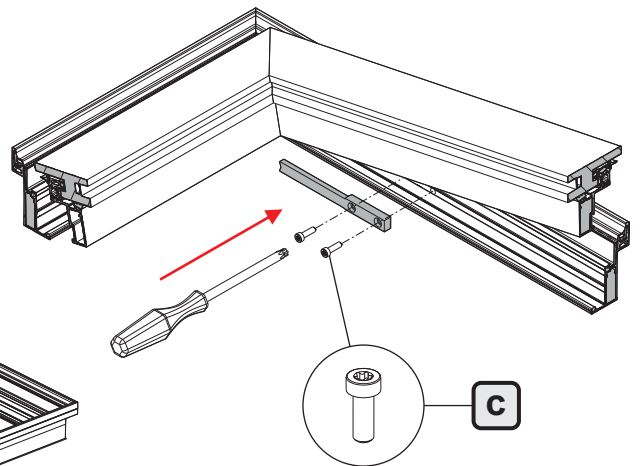

C

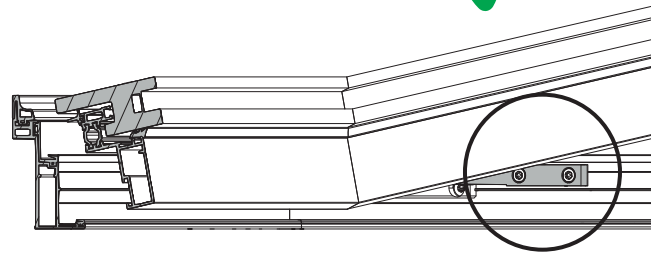
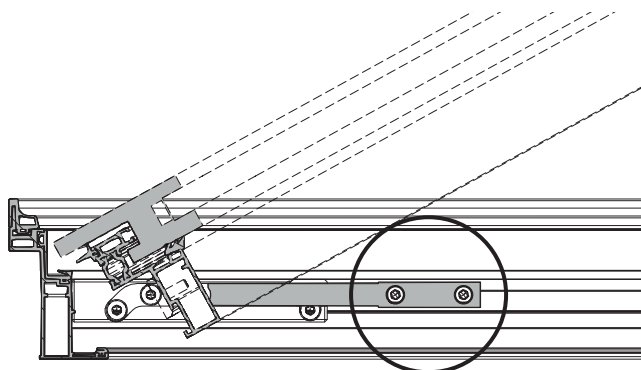

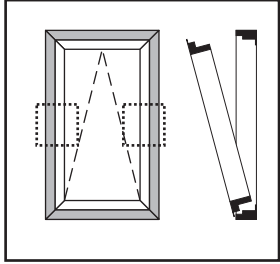

8

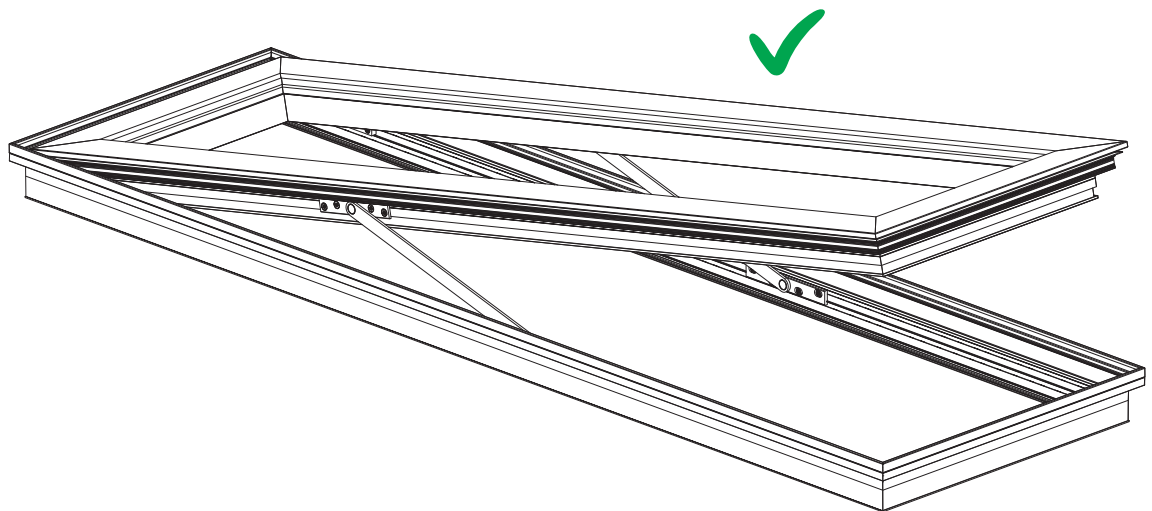
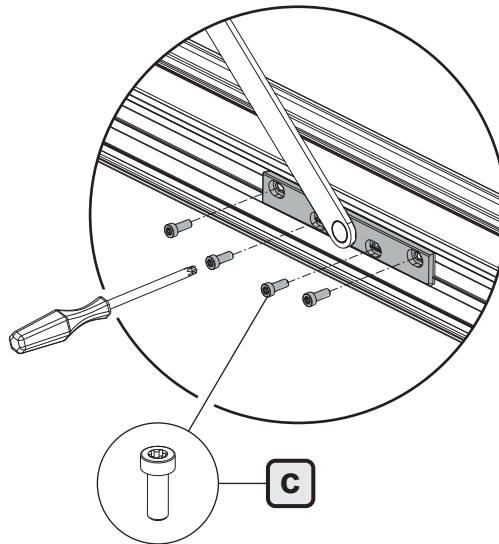
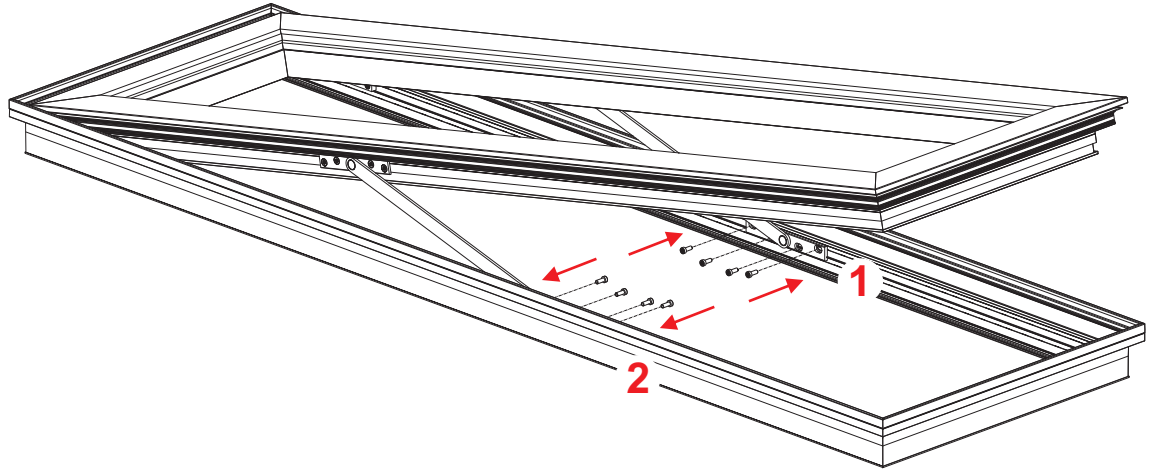

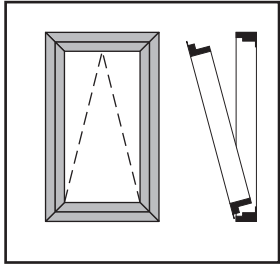

9

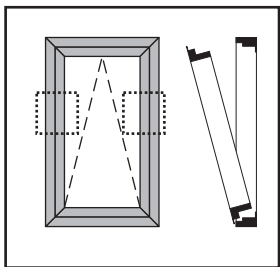
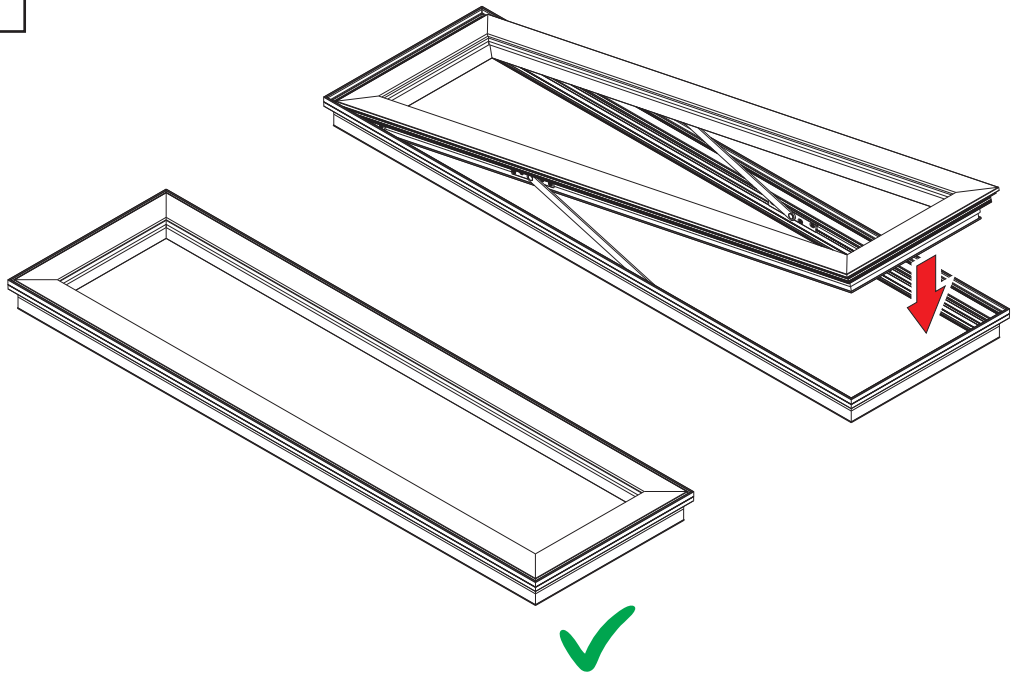

10 FRAME

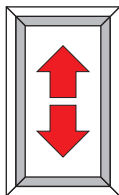

Regolazioni - Adjustments - Réglages -
Regulaciones - Einstellungen - Регулировки

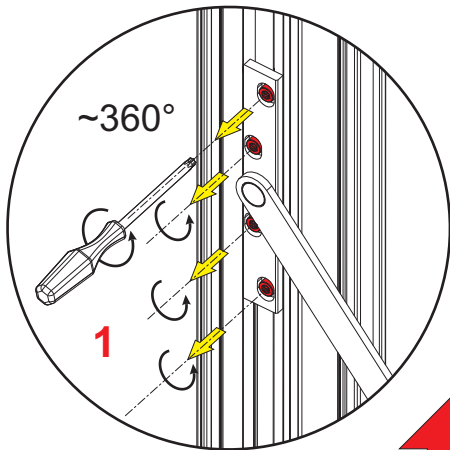

1

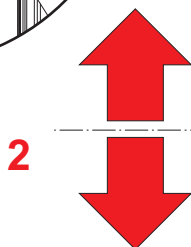

2

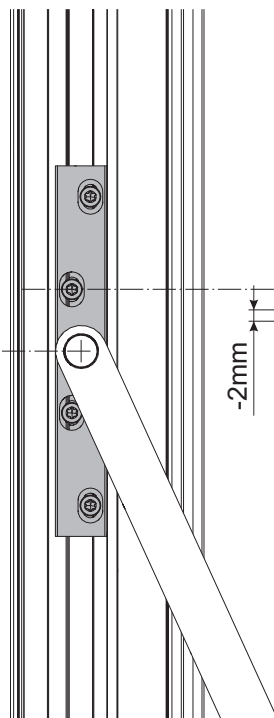

-2mm

+2mm

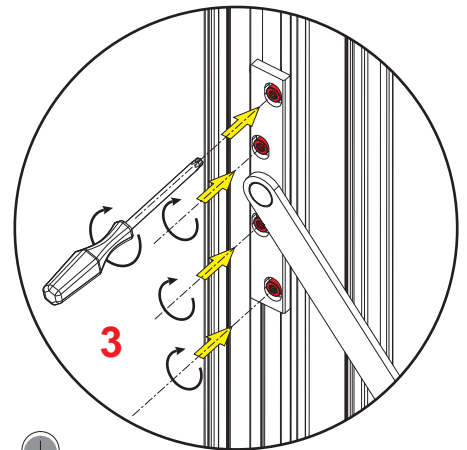

3