

11110000/06-2023

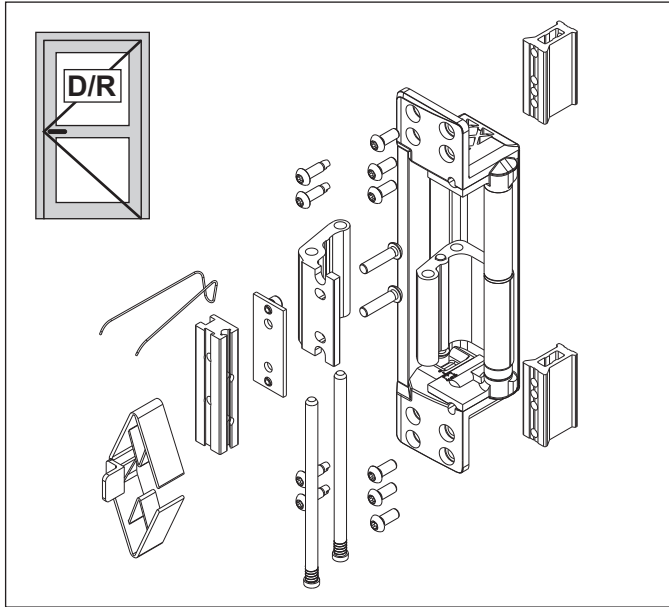

CE	GIESSE S.p.A. Via Tubertini, 1 40054 Budrio Bologna - Italy		23							
	1309	CPR-0491	4	7	7	0	1	4	1	14
EN 1935:2002/AC:2003										

Una copia della Dichiarazione di Prestazione (DoP) del prodotto è disponibile sul sito GIESSE (www.tyman-international.com)
 A copy of the Declaration of Performance (DoP) of the product is available on GIESSE website (www.tyman-international.com)

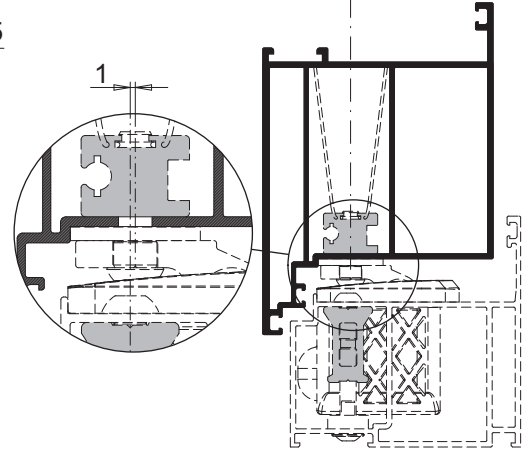
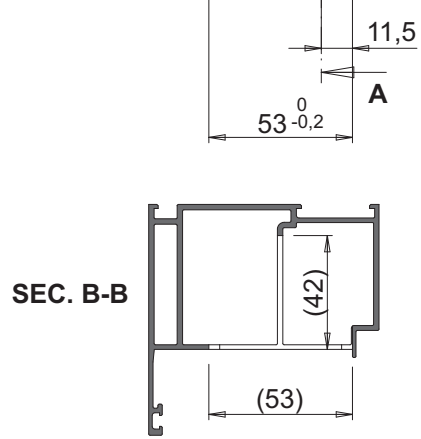
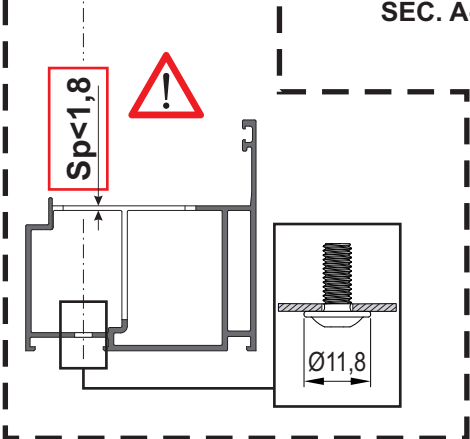
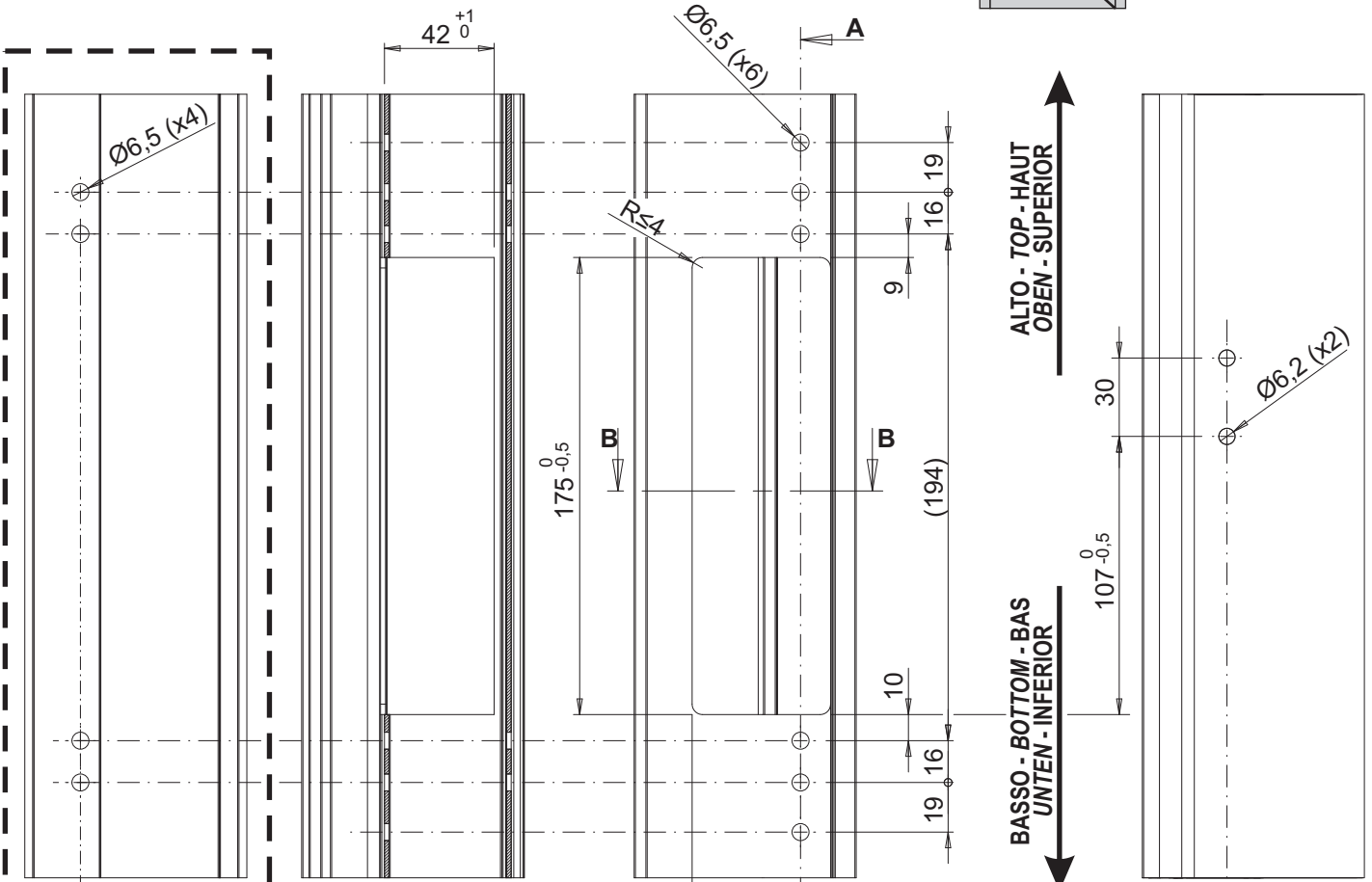
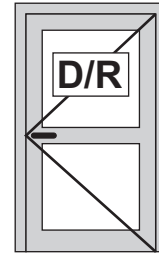

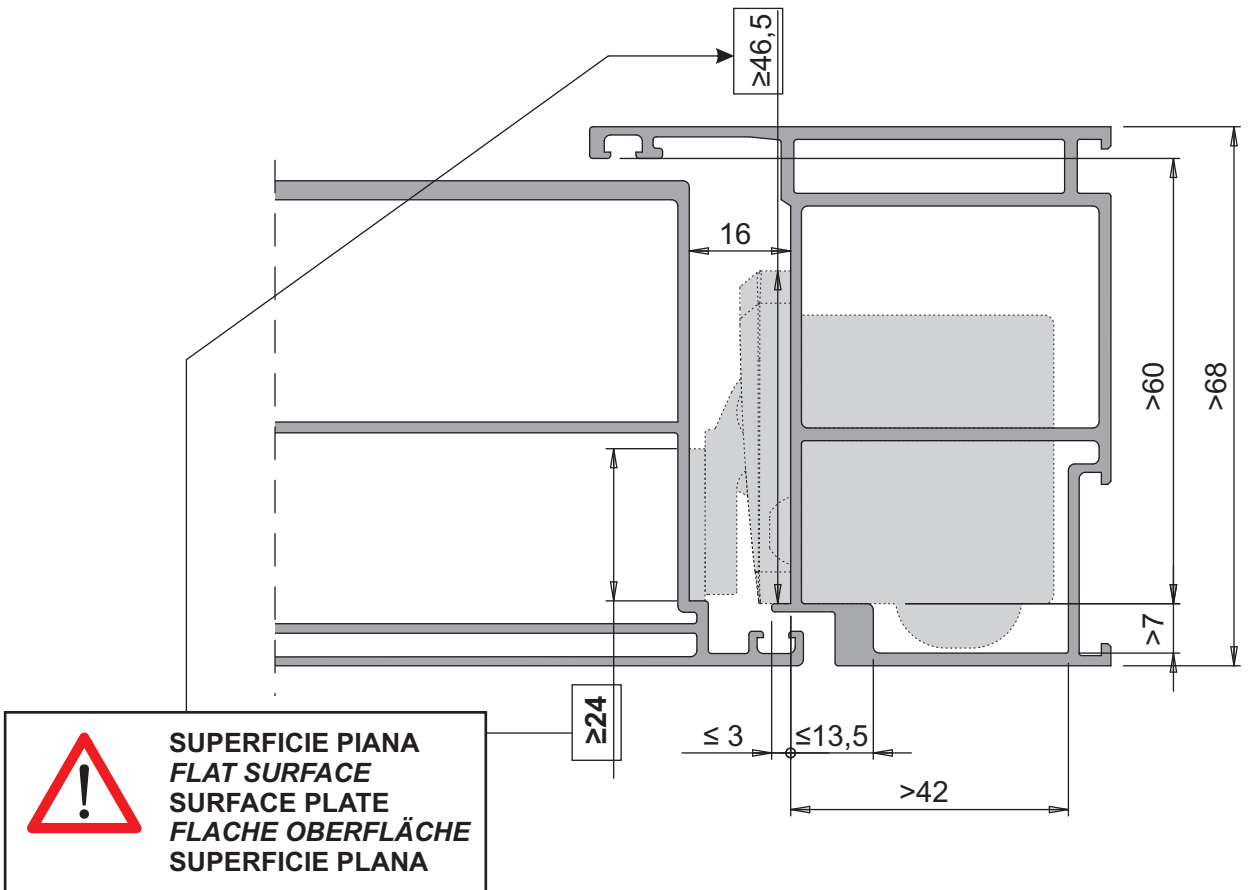
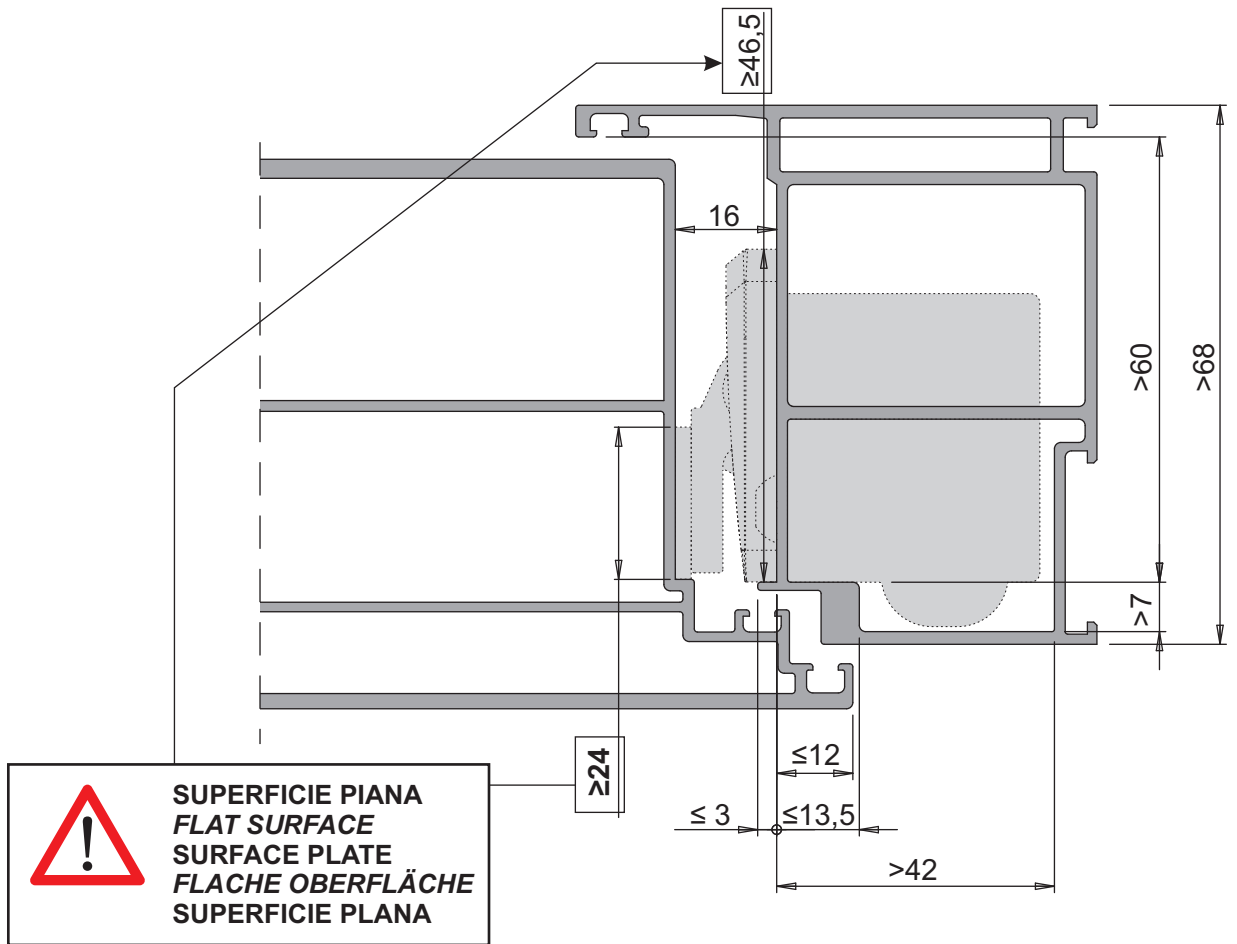

X	Y
9,5 mm	~95°
11 mm	~90°

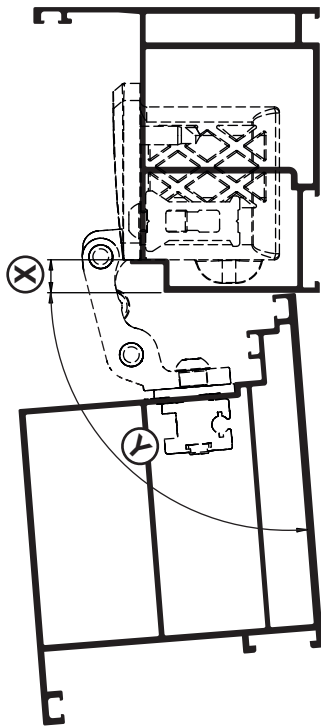
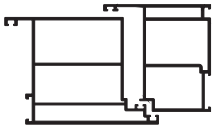

X	Y
Max. 19 mm	~95°

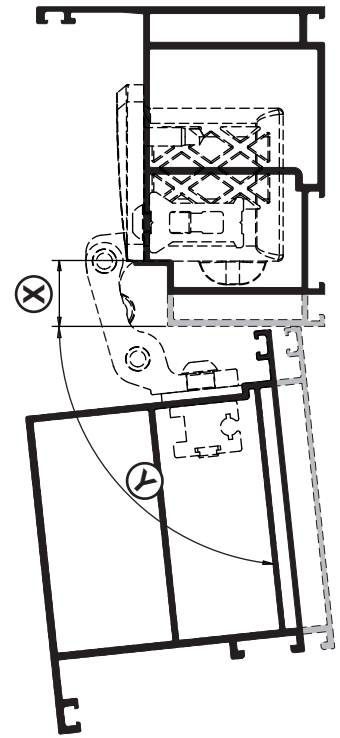
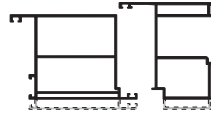

Torx 15



Torx 30



3



4

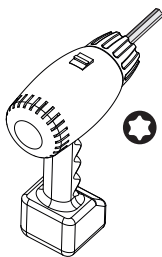

Torx 30

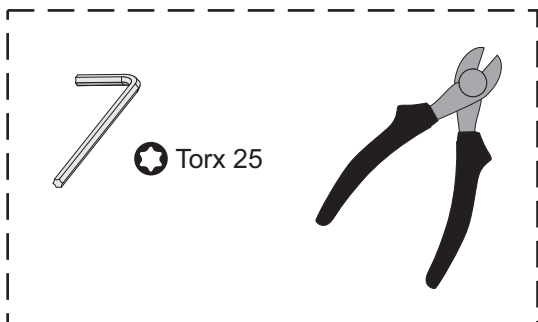

Torx 25

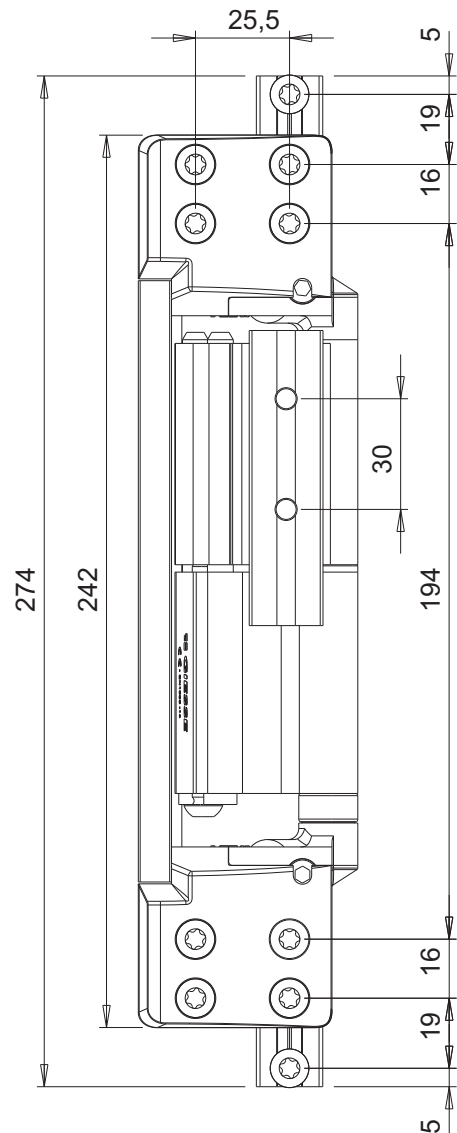



Tabella delle portate massime - *Maximum load chart* - Tableau des charges maximum
 Tabelle der maximalen Tragfähigkeiten - Tabla de capacidades máximas

Pmax				
$K \geq 1,8$	160 kg	160 kg	160 kg	107 kg
$K = 1,6 \div 1,8$	160 kg	160 kg	160 kg	107 kg

Obbligatorio - *Mandatory*
 Obligatoire - *Obligatorisch*
 Obligatorio

00755000

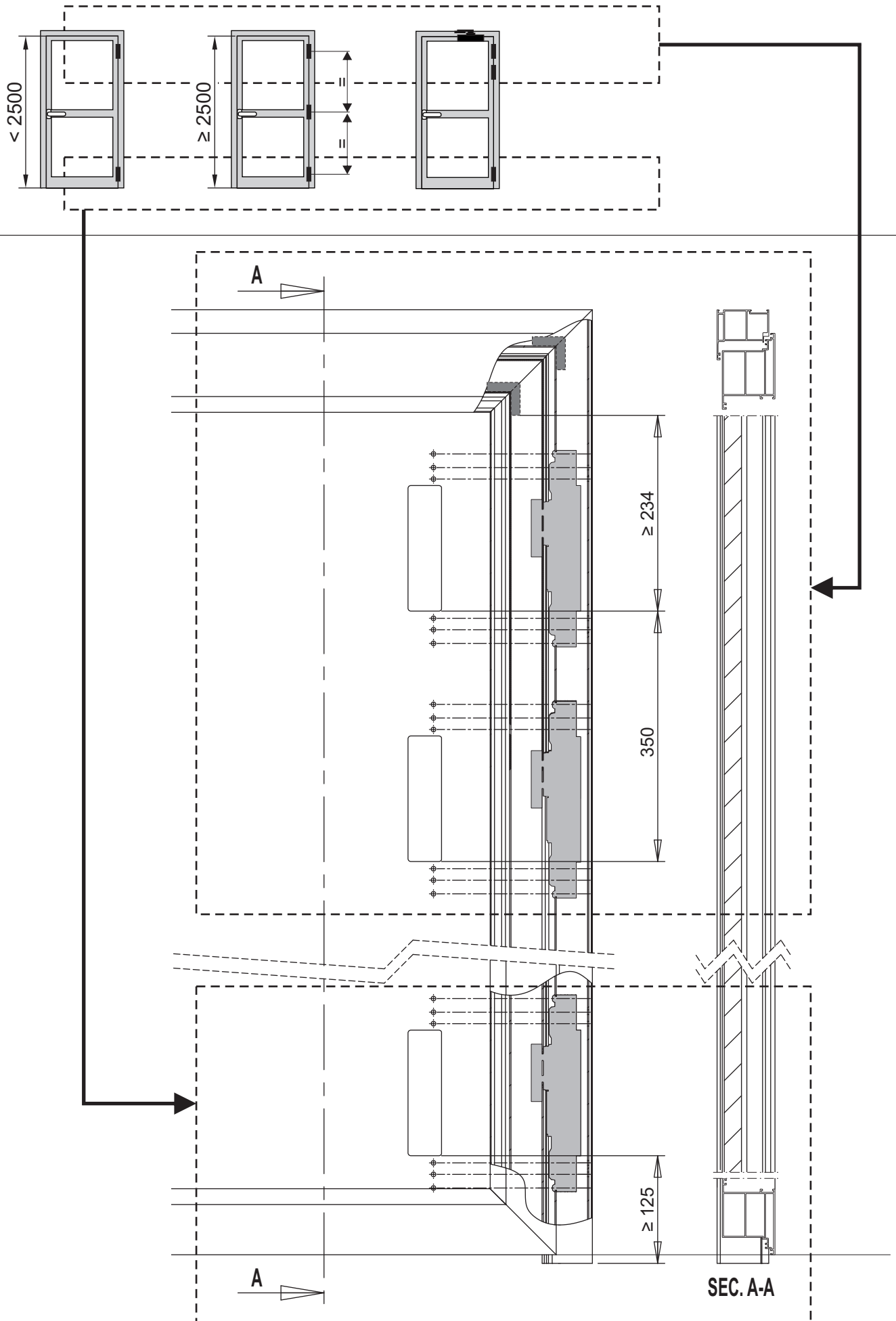
$K < 1,6$

Contattare Servizio Assistenza clienti Giesse
 Contact Giesse customer Service
 Contacter le Service client Giesse
 Wenden Sie sich an den Kundendienst von Giesse
 Contactar con el Servicio al cliente de Giesse

Obbligatorio: limitatore di apertura.
 Mandatory: opening limiter.
 Obligatoire: limiteur d'ouverture.
 Obligatorisch: Öffnungsbegrenzung.
 Obligatorio: limitador de apertura.

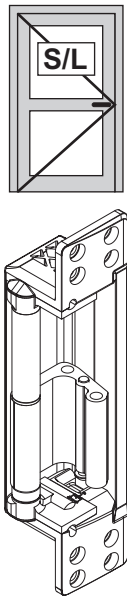
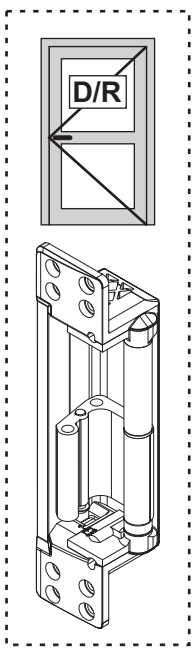

A

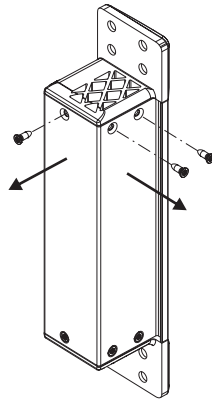

 Torx 15

B

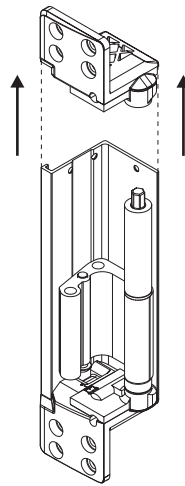

C

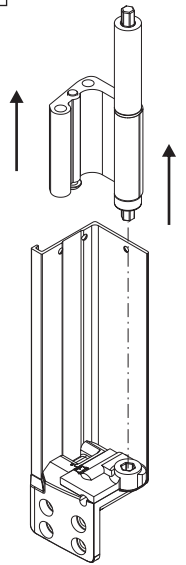

D

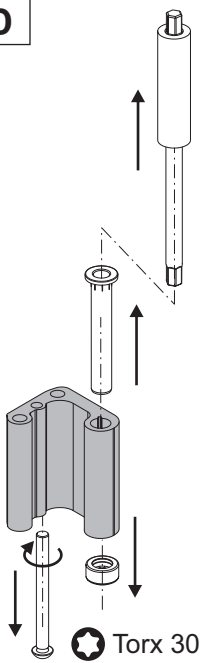

 Torx 30

E

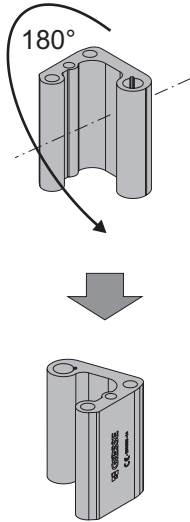

F

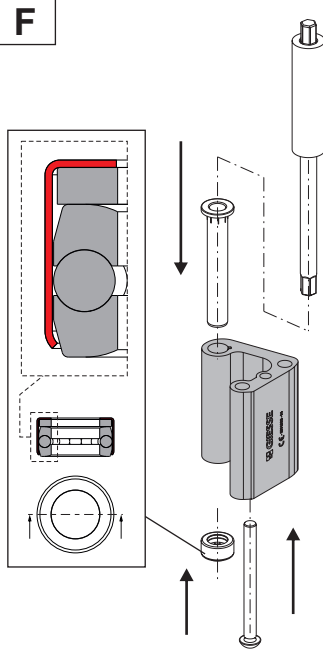

G

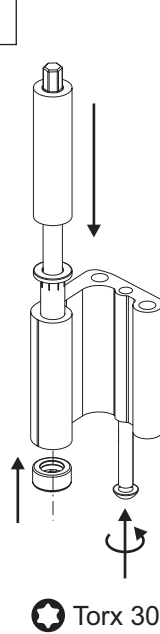

 Torx 30

H

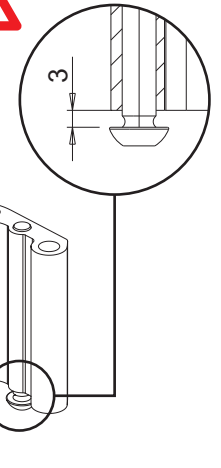

I

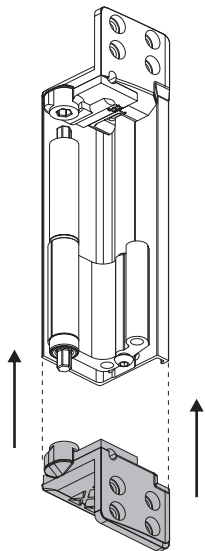

L

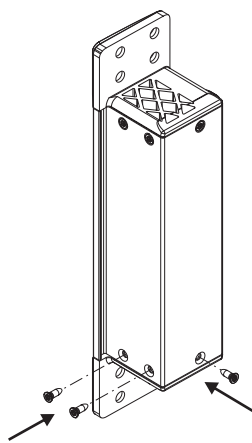

 Torx 15

$\leq 3 \text{ Nm}$

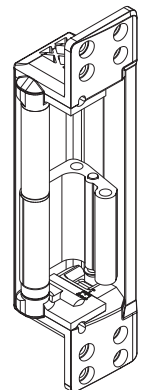
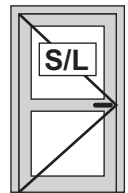

1

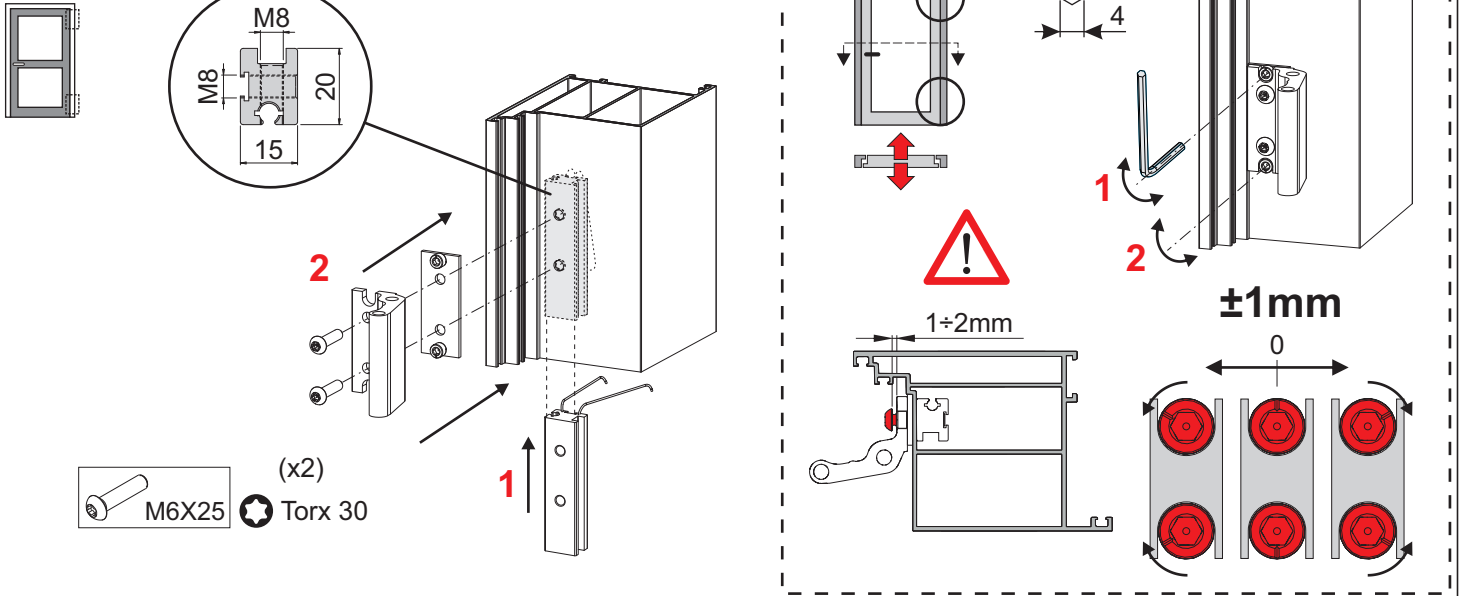

2

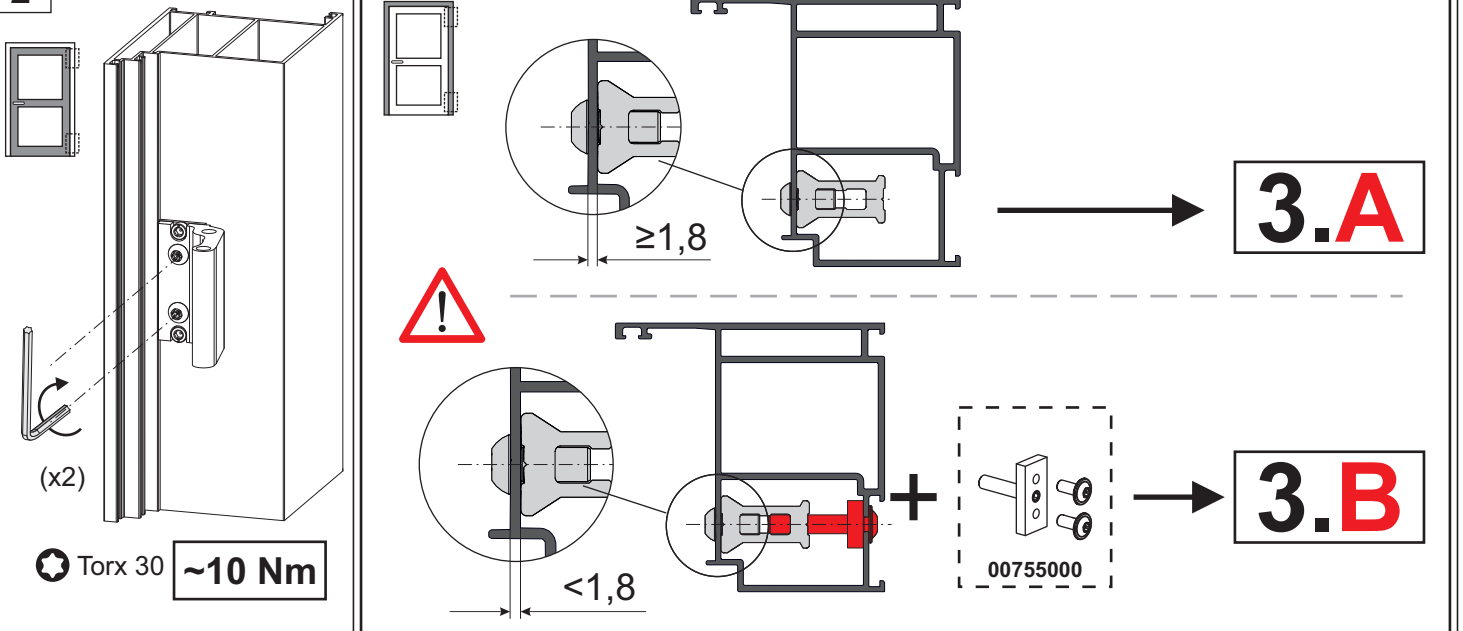

3.A.1

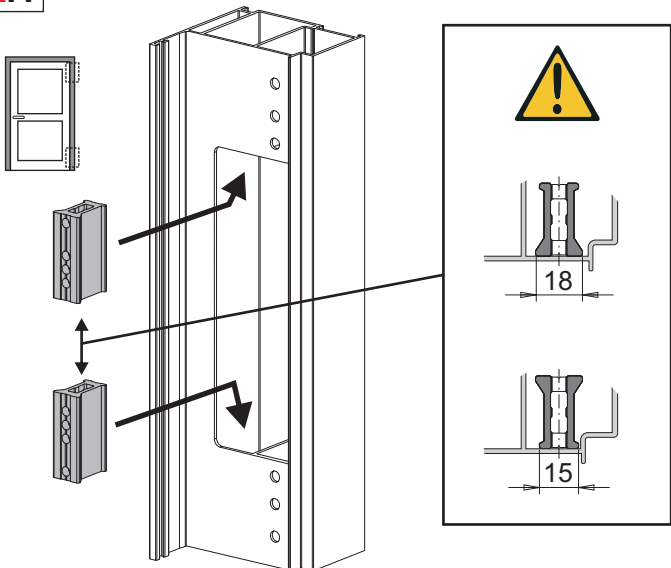

3.A.2

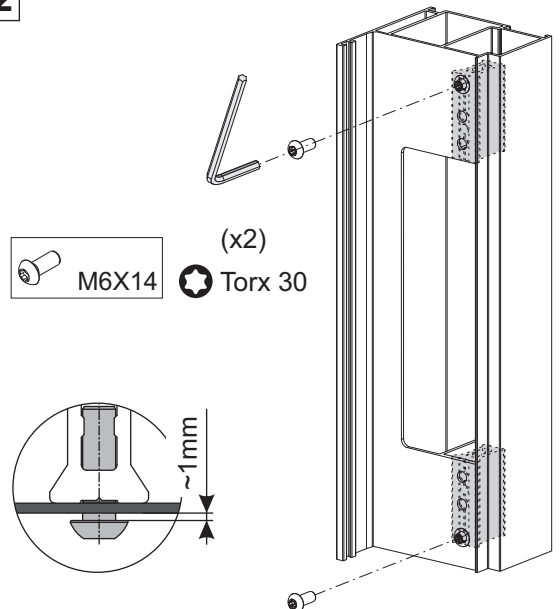

3.B.1

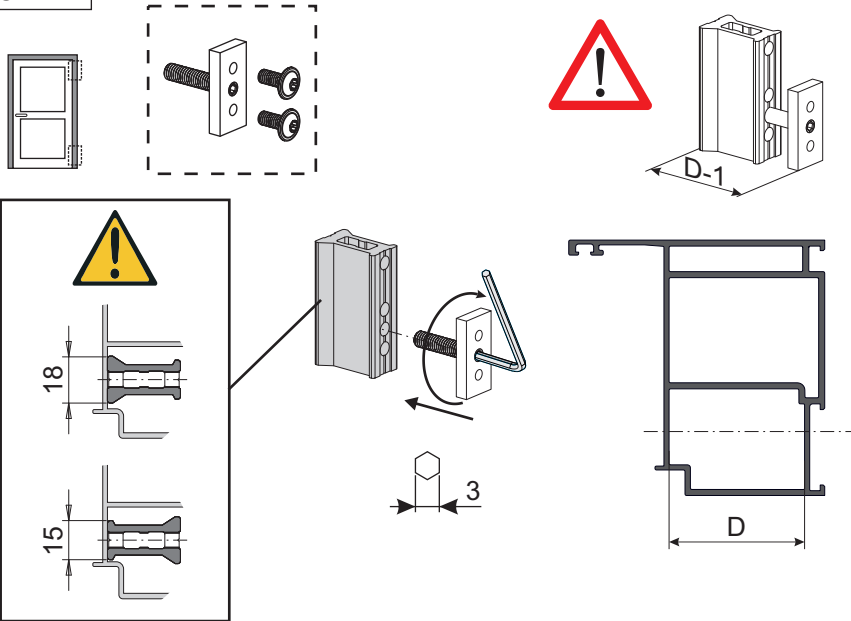

3.B.2

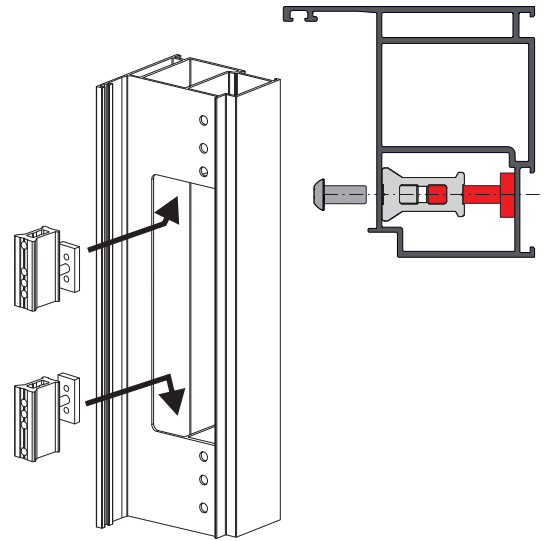

3.B.3

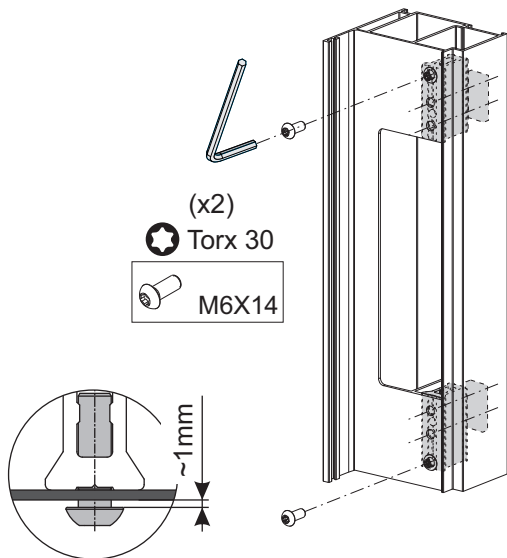

3.B.4

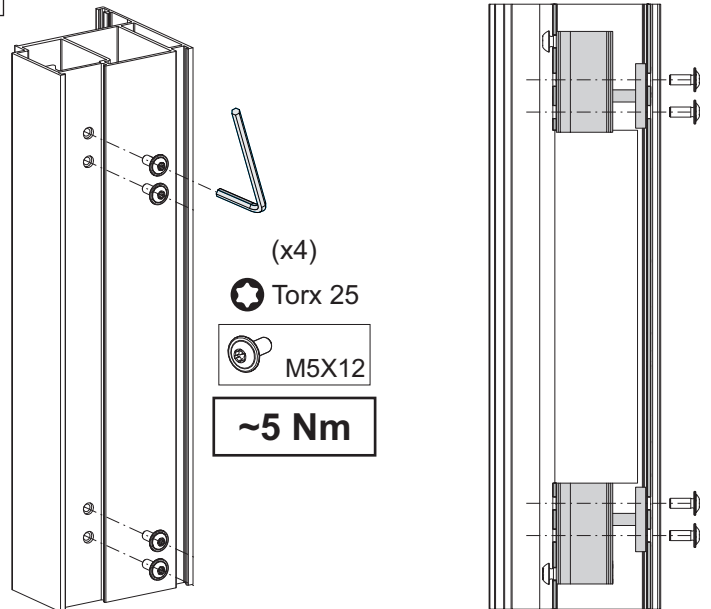

4

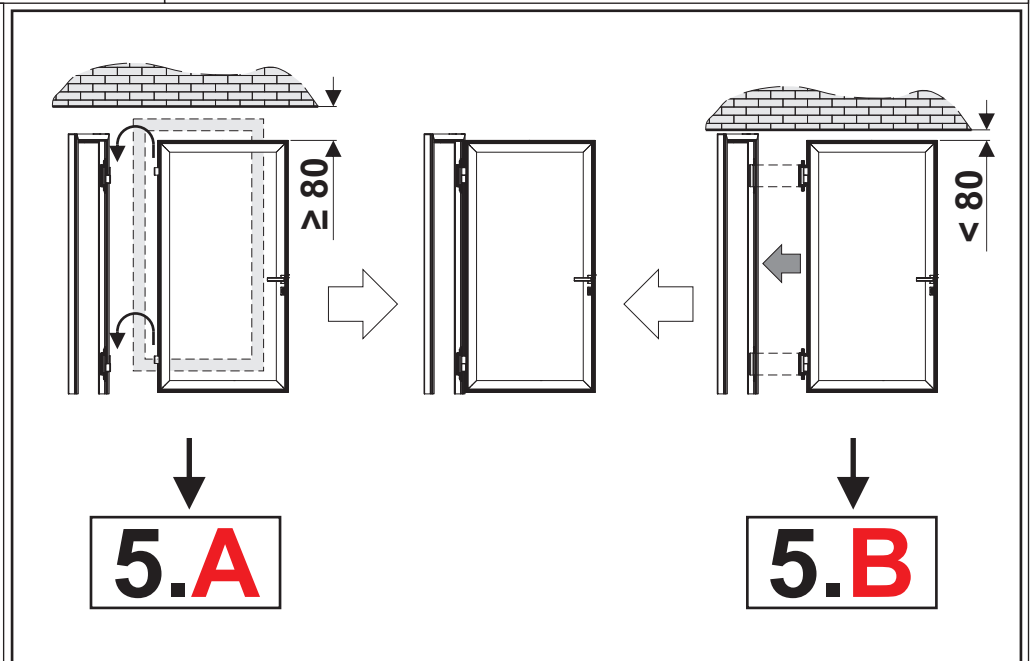
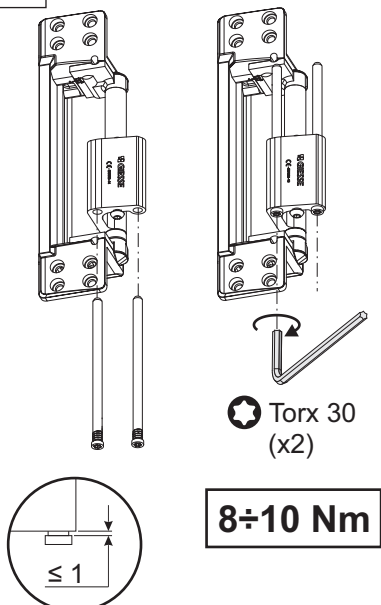

5.A.1

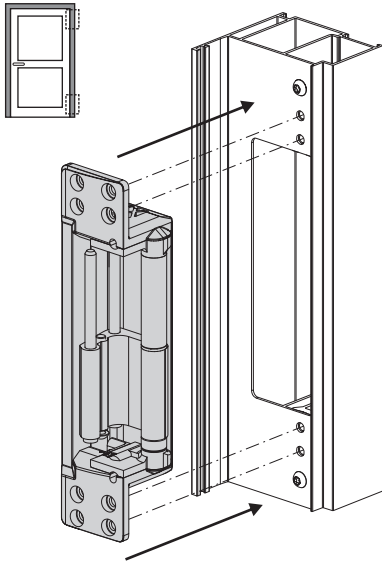

5.A.2

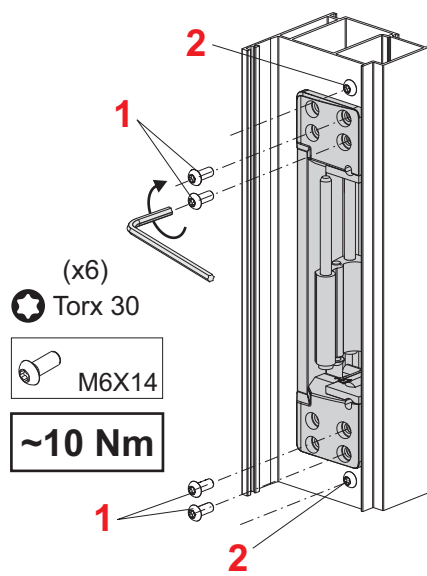

5.A.3

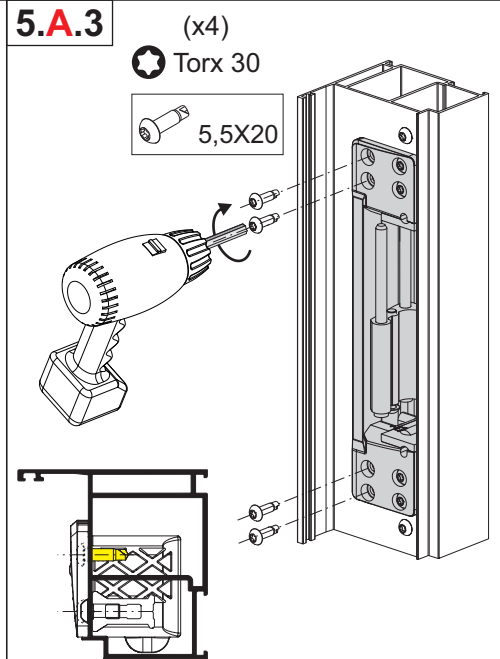

5.A.4

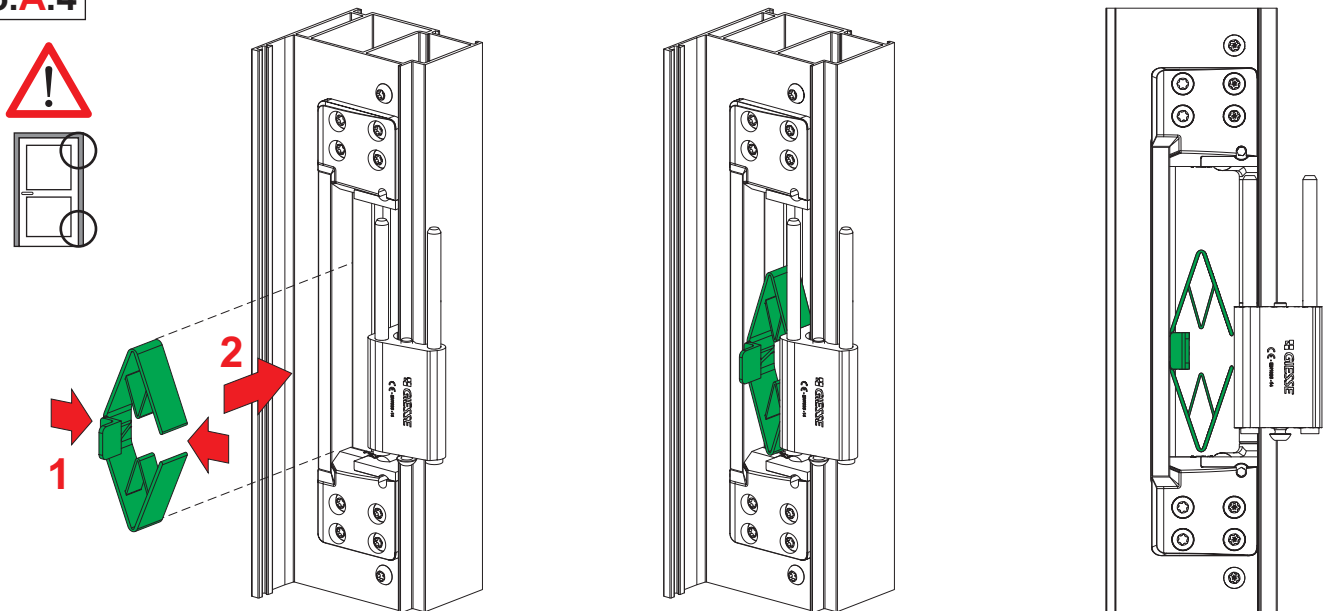

5.A.5

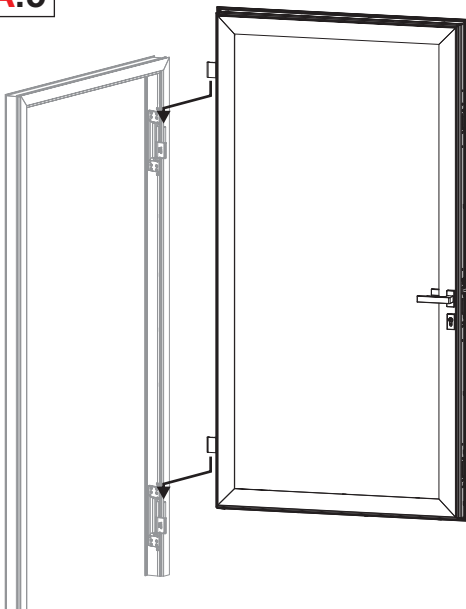

5.A.6

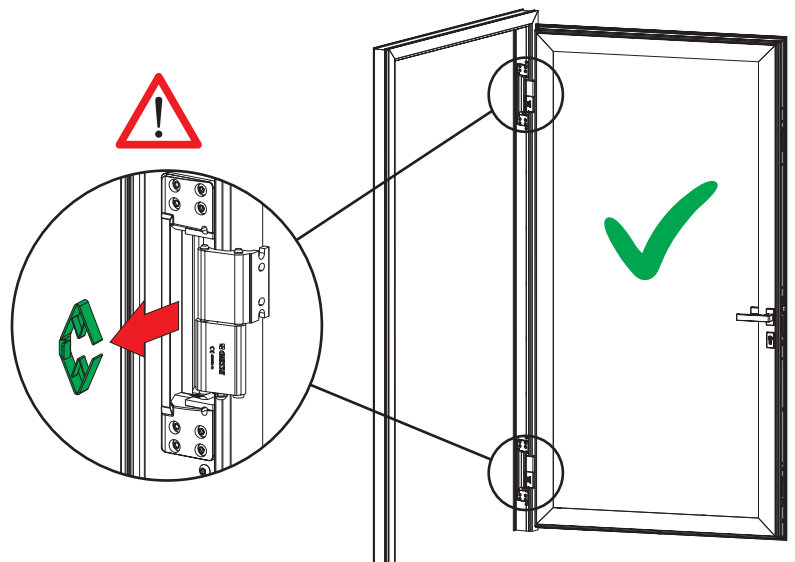

5.B.1

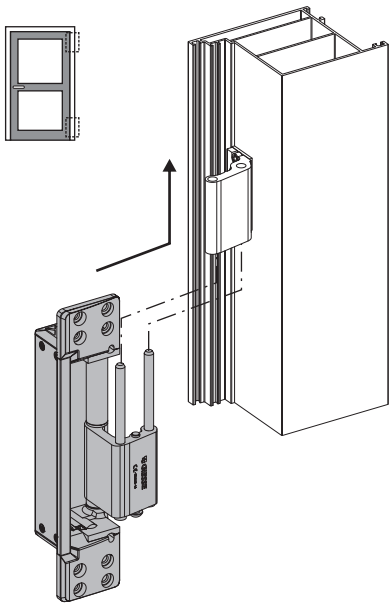

5.B.2

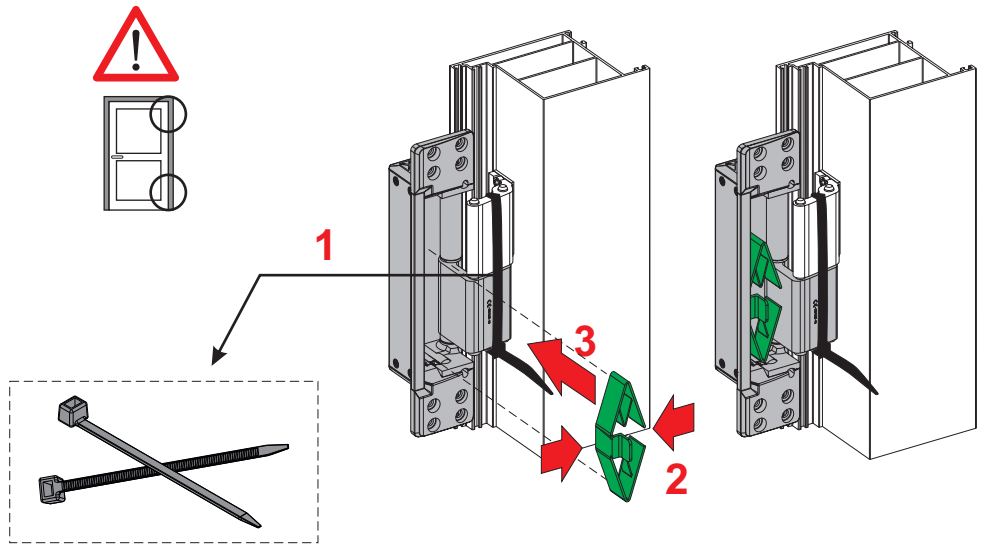

5.B.3

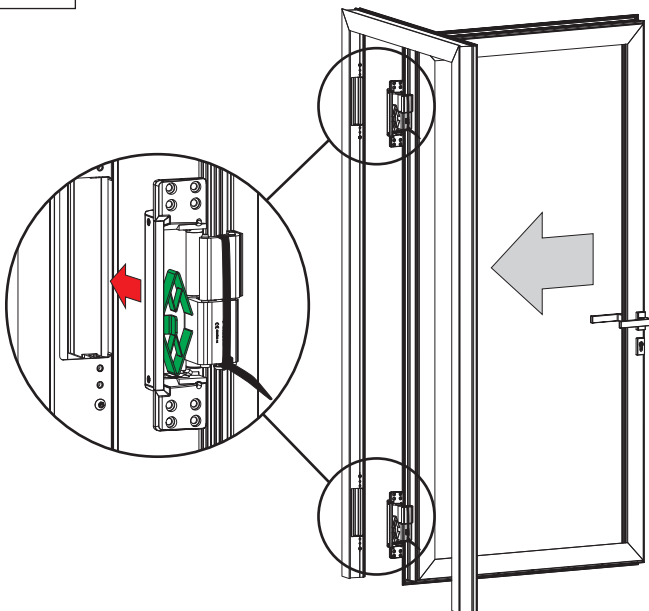

5.B.4

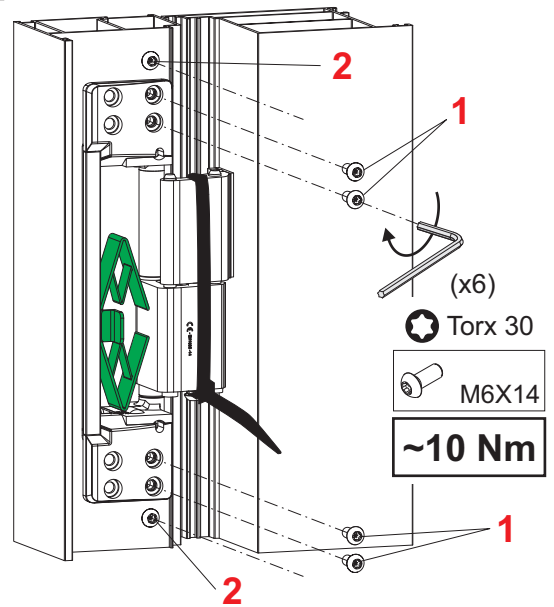

5.B.5

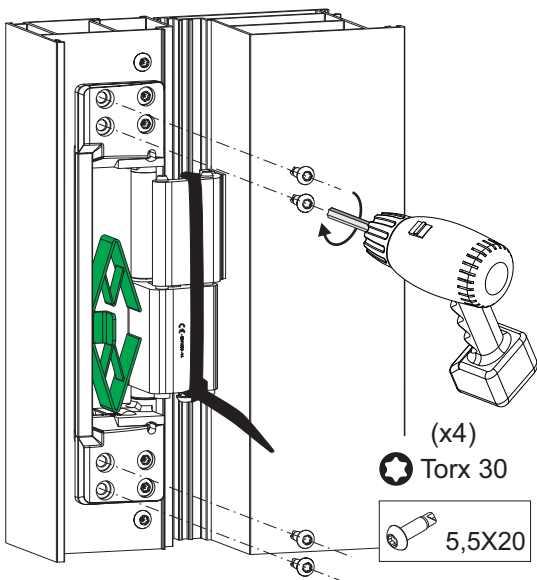

5.B.6

