

GS1000-HD ADDITIONAL ARM

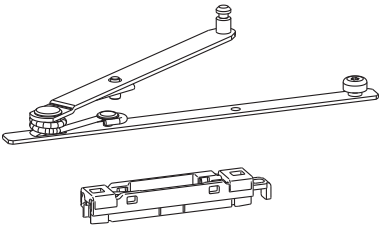

Functions
Additional arm for GS1000-HD tilt-and-slide system.

Online data sheet



Technical features
The additional arm, thanks to the special spring, facilitates opening the sash in the case of heavy weights.
The element must be installed between the two arms of the GS1000-HD hardware set for sashes weighing more than 160 kg or weighing more than 100 kg and sash profile width > 75 mm.

Materials
Steel arm
Sliders of steel and polyamide

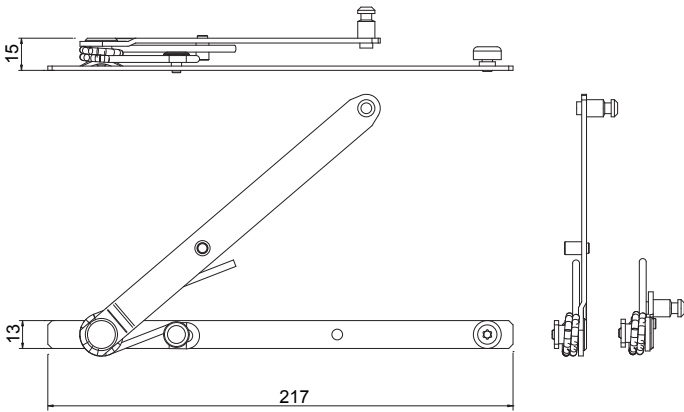

Item code	Description	Range [mm]	PROFILE CROSS - SECTION	GS1000-ML	GS1000-HL	GS1000-HD 100	GS1000-HD 160	GS1000-HD 200	Base Raw	Anodised Elox	Painted	Trend/Gold Brass	Pieces per pack
09759	ADDITIONAL ARM	-	-	-	-	-	X	X	X				1