

## LIMITATION ARMS WITH BLOCK



### Functions

The limitation arm with block limits the Top-hung or Side-hung sash to a maximum opening position and is able to lock it in that position by movement of the mechanism.

Online data sheet



### Technical Features

For safety reasons, it is often required that the sash can be locked in its maximum limited opening position. Giesse has devised a new concept of secure outward opening: the closing system, by means of the rotation of the window handle/cremone, is able to keep the sash locked in its maximum limited opening position but, if necessary, it also allows the sash to move to the "fully open" position.

In a Top Hung or Side hung window, by applying 2 limitation arms with block, in combination with other Giesse products, the following opening types can be obtained:

- closed sash and gripped locking points: handle operated at 0°
- sash which can be opened freely up to the maximum limitation position: handle operated at 90°
- sash in maximum locked opening position: handle operated at 0°
- sash which can be opened up to the maximum opening position: operated at 180°

The product is applicable in top-hung systems with stack (sash/frame distance) of 17 mm.

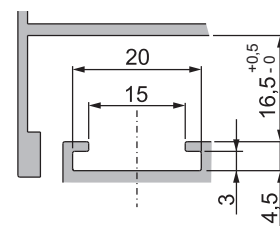

### Top-Hung configuration example

| Description                     | Qty | Item code                                  |
|---------------------------------|-----|--|
| Limitation arm with lock        | 2   | 01700                                      |
| Ghibo Plus CW1 mechanism        | 1   | 02079                                      |
| Futura corner drive             | 2   | 04020K                                     |
| Fixed pawl                      | 4   | 04049                                      |
| Adjustable striker for frame    | 4   | 01396                                      |
| Window handle                   | 1   | product selected from the Giesse catalogue |
| Sash centering and lifting unit | 2   | 01717                                      |
| Burglar bolt for curtain wall   | 1   | 01410                                      |

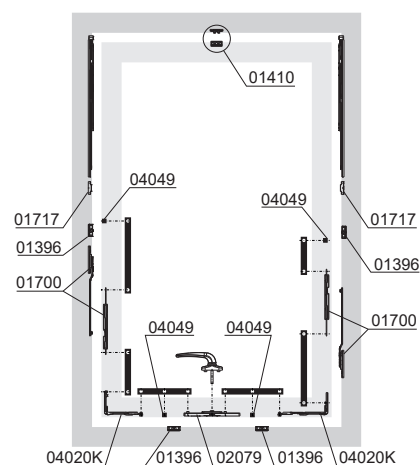

### Side-Hung configuration example

| Description                     | Qty | Item code                   |
|---------------------------------|-----|-----------------------------|
| Limitation arm with lock        | 2   | 01700                       |
| Rod driving device              | 1   | 04098001/04099001           |
| Futura corner drive             | 2   | 04020K                      |
| Fixed pawl                      | 4   | 04049                       |
| Adjustable striker for frame    | 4   | 01396                       |
| Unica one-way cremone           | 1   | depends on profile geometry |
| Sash centering and lifting unit | 1   | 01717                       |

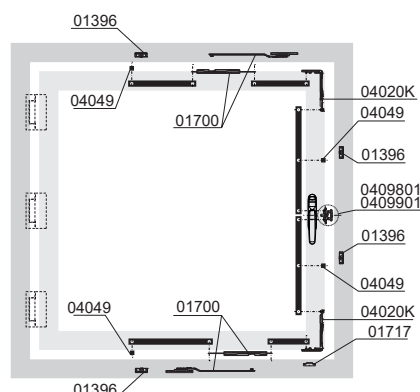

| Item code | Description               | Note        | Base Raw | Anodised Elox | Painted | Trend/Gold Brass | Pieces per pack |
|-----------|---------------------------|-------------|----------|---------------|---------|------------------|-----------------|
| 01700     | LIMITATION ARM WITH BLOCK | 17 mm stack | X        |               |         |                  | 10              |