

FLUSH CHIC 3D 100 HINGES AND ARMS

Functions

Set of hinges (top and bottom), completely pre-assembled and ready to be installed on the profile.

Technical Features

They enable tilt-and-turn opening combined with the mechanisms.

Micro-ventilation and logica versions.

The arm is equipped with micro-ventilation as standard (adjustable).

Moving the fastening pawl takes the arm from conventional to logica.

The T2 arm is adjustable: the opening "A" goes from 178 mm (base) to 148 mm.

Materials

Corner support made of zamak

Connecting brackets and hinge plates made of zinc plated steel

Pins made of 304 grade stainless steel and aluminium bronze

Cams made of zinc plated steel

Connecting bracket and arm rod made of 304 grade stainless steel

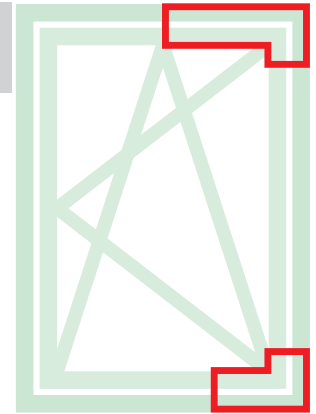

Online data sheet



052912

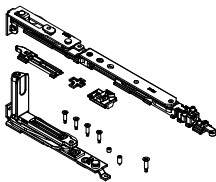

052911

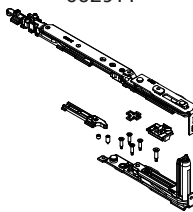

052922

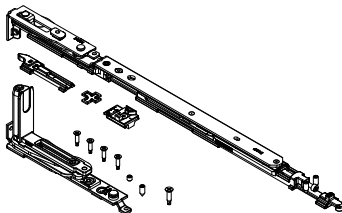

052921

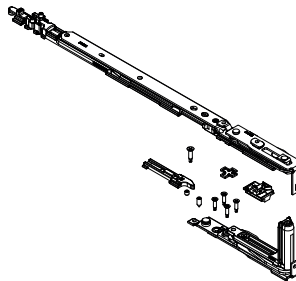

$\alpha^\circ \text{ MAX} = 105^\circ$

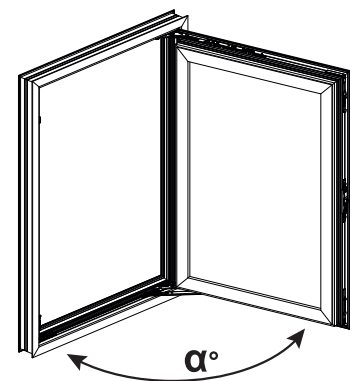

Sash opening

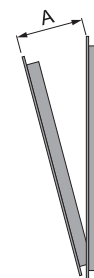

Item code	Description	PROFILE CROSS - SECTION	Range (mm)	Version	A (mm)	Hand	Base Pawl	Anodised Elox	Painted	Trend/Gold Brass	Pieces per pack
052911	CHIC 100 FLUSH - AR ARM T1 KIT	C013-C014-C015-C016-017	W 485 ÷ 700	Micro	98	RX	X				10
052912	CHIC 100 FLUSH - AR ARM T1 KIT	C013-C014-C015-C016-017	W 485 ÷ 700	Micro	98	LX	X				10
052921	CHIC 100 FLUSH - AR ARM T2 KIT	C013-C014-C015-C016-017	L 600 ÷ 1500	Micro	148÷178	RX	X				10
052922	CHIC 100 FLUSH - AR ARM T2 KIT	C013-C014-C015-C016-017	L 600 ÷ 1500	Micro	148÷178	LX	X				10