

## FUTURA 3D 170 HP INVISIBLE ADDITIONAL FASTENING MECHANISMS AND ACCESSORIES

### Functions

The FUTURA 3D 170 HP Invisible tilt-and-turn window has a basic load capacity of 130 kg, to obtain a maximum load capacity of 170 kg you need to use the reinforcement set. This product is designed for sash profiles with a smooth channel. In the case of profiles with a machined channel, shims of 1.5 mm and 2 mm must be used.

The additional fasteners make it possible to add further fastening elements that either increase the dimensions of the casement or that can be used when locking points are needed on the cross beams or hinge-side upright.

On the basis of the dimensions of the casement, additional fasteners (for H>1200 mm and W>1000 mm) and the additional arm (which is mandatory for W>1000 mm) are to be used in combination with this mechanism.

The micro-ventilation device can be fitted at any time, even after the window is installed. When activated with the cremone at 180° there is micro-ventilation (precision sash opening), when it is not activated, with the cremone at 180° there is tilt-and-turn opening.

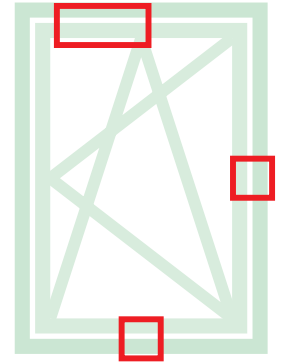

Online data sheet



03520

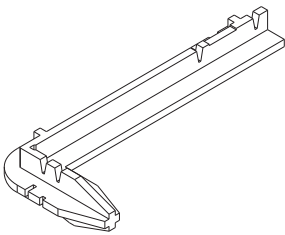

04012

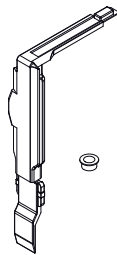

04014K

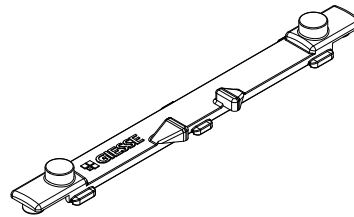

04019K

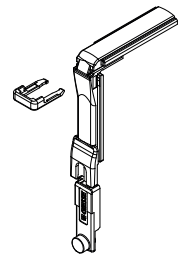

04020K

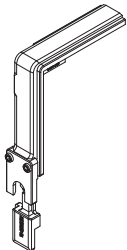

04024K

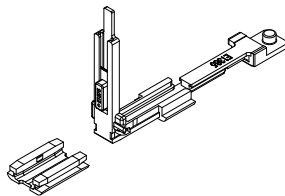

04026K

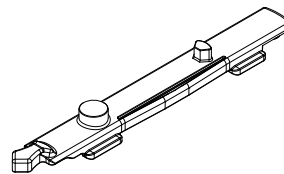

04301K

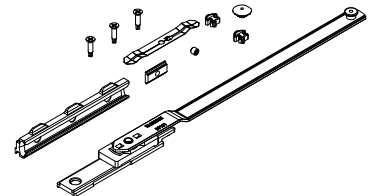

04311

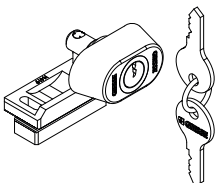

04407

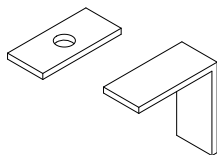

04409

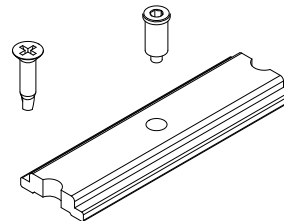

04411

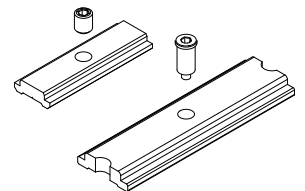

04770K

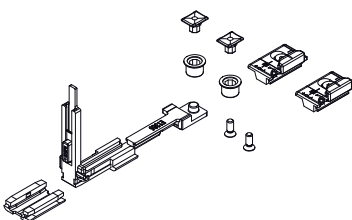

04777K

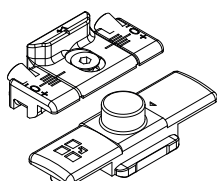

### Micro-ventilation

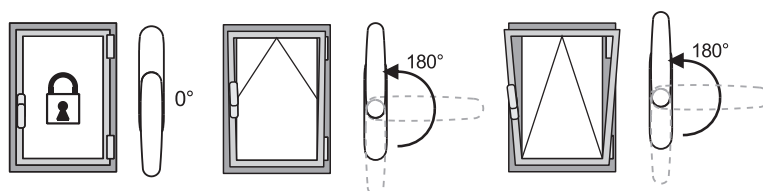

| Item code | Description                                    | PROFILE CROSS - SECTION  | Range (mm)           | Version | Base Raw | Anodised Elox | Painted | Trend/Gold Brass | Pieces per pack |
|-----------|--|--|----------------------|---------|----------|---------------|---------|------------------|-----------------|
| 03520     | TEMPLATE FOR AR FUTURA                         | C001-C002-C003-C004-C005-C006-C011-C012-C013-C014-C015-C016-C017   | -                    | -       | X        |               |         |                  | 20              |
| 04012     | CORNER DRIVE FOR FUTURA 170HP INVISIBLE        | C001-C002-C003   | H > 1200             | -       | X        |               |         |                  | 10              |
| 04014K    | FUTURA T/T DRIVE ROD                           | C001-C002-C003-C004-C005-C006-C013-C014-C015-C016-C017   | -                    | -       | X        |               |         |                  | 10              |
| 04019K    | CORNER DRIVE GROOVE 15/20 FUTURA               | C001-C002-C003-C004-C005-C006-C009-C010-C011-C012-C013-C014-C015-C016-C017   | -                    | -       | X        |               |         |                  | 10              |
| 04020K    | FUTURA CORNER DRIVE                            | C001-C002-C003-C004-C005-C006-C009-C010-C011-C012-C013-C014-C015-C016-C017-P001-P002-P003-P004-P005-P006-P007-P008-P009-P010 | -                    | -       | X        |               |         |                  | 50              |
| 04024K    | CORNER DRIVE FOR FUTURA BURGLAR-PROOF FUNCTION | C001-C002-C003-C004-C005-C006-C013-C014-C015-C016-C017   | -                    | -       | X        |               |         |                  | 10              |
| 04026K    | FUTURA T/T BOLT TIP                            | C001-C002-C003-C004-C005-C006-C013-C014-C015-C016-C017   | -                    | -       | X        |               |         |                  | 10              |
| 04301K    | T/T FUTURA ADDITIONAL ARM                      | C001-C002-C003-C004-C005-C006  | W > 1000             | -       | X        |               |         |                  | 5               |
| 04311     | SASH OPENING BLOCK LOCK                        | C001-C002-C003-C004-C005-C006-C007-C013-C014-C015-C016-C017  | -                    | -       | X        |               |         |                  | 10              |
| 04407     | SHIMS FOR FUTURA 3D 170 HP INVISIBLE           | C001-C002-C003   | 2                    | -       | X        |               |         |                  | 10              |
| 04409     | REINFORCEMENT FOR FUTURA 170 HP INVISIBLE      | C001-C002  | 130 -> 170 Kg        | -       | X        |               |         |                  | 10              |
| 04411     | REINFORCEMENT FOR FUTURA 170 HP INVISIBLE      | C003   | 130 -> 170 Kg        | -       | X        |               |         |                  | 10              |
| 04770K    | FUTURA ADDITIONAL FASTENING MECHANISM          | C001-C002-C003-C004-C005-C006-C013-C014-C015-C016-C017   | H > 1200<br>L > 1000 | -       | X        |               |         |                  | 10              |
| 04777K    | FUTURA ADDITIONAL FASTENING MECHANISM          | C001-C002-C003-C004-C005-C006-C013-C014-C015-C016-C017   | H > 1200<br>L > 1000 | Logica  | X        |               |         |                  | 50              |