

KORA 0-180 CREMONE

Functions

Reversible cremone for operating GIESSE mechanisms.

Online data sheet



Technical Features

Available either with two-way mechanism for sashes or in the APEX version. The Kora cremone is supplied right-handed and has a fixing C/C distance of 104 mm.

The Kora Apex Cremone can be fitted on shutter profiles or with outward opening, and does not need to use the internal connection kit.

The Apex system, patented by Giesse, is easily and quickly mounted on the sash profile after doing the appropriate machining.

The possible range of the telescopic slider is from 16 mm to 35 mm.

The pins to be used to transfer the motion from the cremone sliders to the rod depend on the specific geometry of the profile and must be chosen from the available ones listed below.

Materials

Handle in painted die-cast aluminium

Case and cover screws made of painted die-cast zamak

Spring made of steel and screw made of zinc plated steel

Shim in Hostaform

Rotor, racks and sliders in die-cast zamak

00964

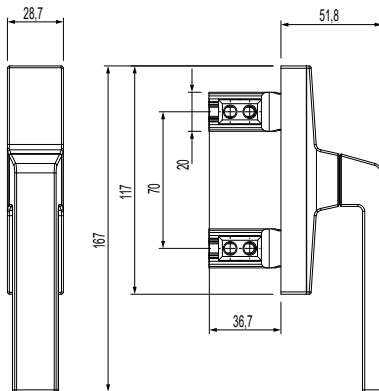
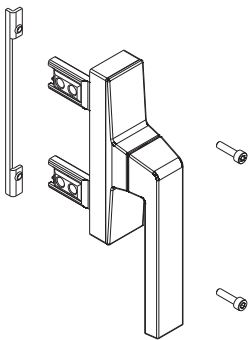

Connection pin

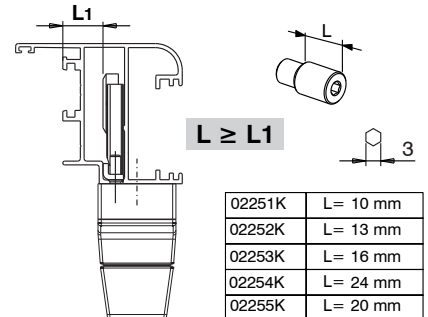

00965

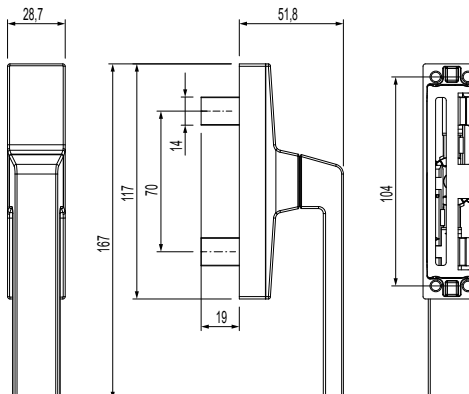
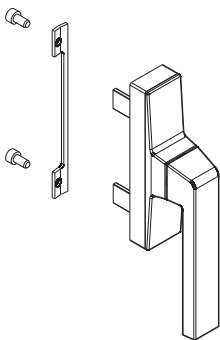

Item code	Description	PROFILE CROSS - SECTION	Hand	C/C distances	Base Raw	Anodised Elox	Painted	Trend/Gold Brass	Pieces per pack
00964	KORA 0-180 APEX CREMONE	C001-C002-C003-C004-C005-C006-C007-C008-C009-C010-C012-C013-C014-C015-C016-C017		104 mm	X		X		10
00965	KORA 0-180 CREMONE	C001-C002-C003-C004-C005-C006-C007-C008-C009-C010-C012-C013-C014-C015-C016-C017		104 mm	X		X		10