

DOMINA STEPS

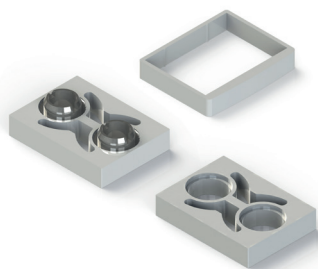

Functions

Steps for combination with DOMINA HP, DOMINA HP COVER and DOMINA CLASSIC hinges for application to non-flush profiles.

Online data sheet



Technical Features

Steps of 7, 8, 9, 10 and 12 mm height for combination with hinges of the DOMINA HP, DOMINA HP COVER and DOMINA CLASSIC range, flush version, designed to compensate for the step in the profile.

Compatible with C/C distances starting from 62,5mm.

Available in two versions:

- with centering bushes, used in combination with counterplate kit and expansion dowels for single sealed unit profiles
- without centering bushes, designed to accept M12 direct fixing screw for thermal break profile

The step, when used in combination with the Cover version hinge, is finished with the relative step concealer.

Materials

Extruded aluminium step
Centering bushes, zinc-coated steel; hinge bodies and screw-cover plates, extruded aluminium
Extruded aluminium cover

Step with bushes

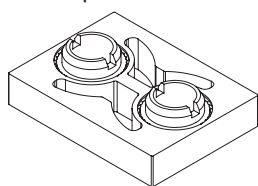

Step without bushes

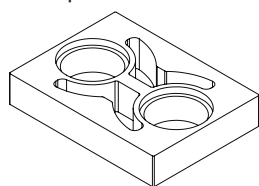

Step cover

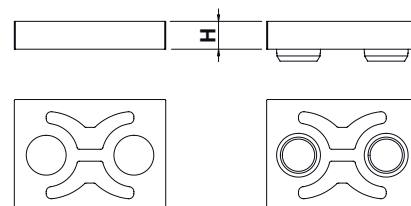
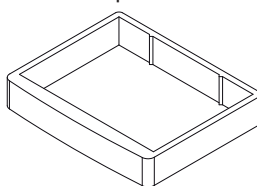

Item code	Description	H [mm]	Hinges HP	Hinges COVER	Hinges CLASSIC	Fixing with M12 screw	Fixing with Counterplate	Fixing with Expansion dowels	Base Raw	Anodised Elox	Painted	Trend/Gold Brass	Pieces per pack
05095	STEP 7 WITHOUT BUSHES	7	x	x	x	x			X	X	X		10
05096	STEP 8 WITHOUT BUSHES	8	x	x	x	x			X	X	X		10
05097	STEP 10 WITHOUT BUSHES	10	x	x	x	x			X	X	X		10
05098	STEP 9 WITHOUT BUSHES	9	x		x	x			X	X	X		10
05195	STEP 7 WITH BUSHES	7	x	x	x		x	x	X	X	X	X	10
05196	STEP 8 WITH BUSHES	8	x	x	x		x	x	X	X	X	X	10
05197	STEP 10 WITH BUSHES	10	x	x	x		x	x	X	X	X	X	10
05198	STEP 9 WITH BUSHES	9	x	x	x		x	x	X	X	X	X	10
05199	STEP 12 WITH BUSHINGS	12	x				x	x	X		X		10
06195N	COVER STEP COVER	7		x							X		10
06196N	COVER STEP COVER	8		x							X		10
06197N	COVER STEP COVER	10		x							X		10