

UNICA SYSTEM CREMONE KIT

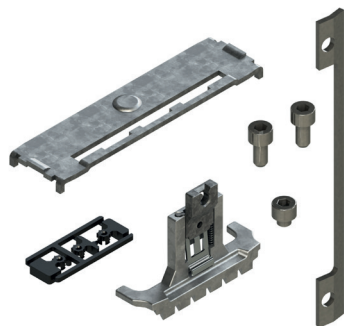

Functions

Components that, added to the Unica Cremone without internal components, enable converting them into the finished product.

Online data sheet



Technical Features

Completion kit that, in combination with the Unica mechanism, enables creating a finished cremone (sash, tilt-and-turn window, etc.). Composed of the internal components and any fixing components (screws and plate), it must be suitably mounted by the window maker.

After the assembly phase the cremone is ready to be installed.

The method of assembly of the kit is adequately explained in the fitting instructions.

Materials

Black polyamide plate (zinc plated steel for tilt-and-turn window version)

Sliders and Racks in zinc plated die-cast zamak
Stainless steel screws and fixing plate

Art. 02259

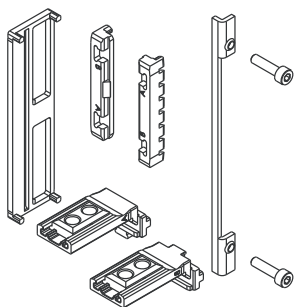

Art. 02403

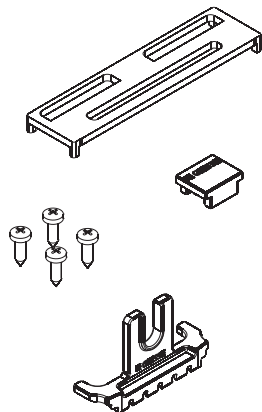

Art. 02407

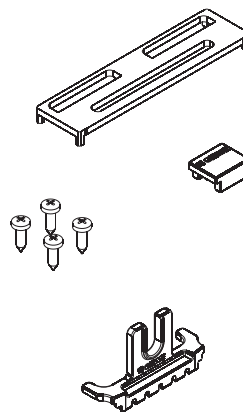

Art. 02408

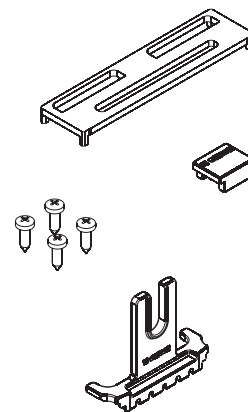

Art. 02409

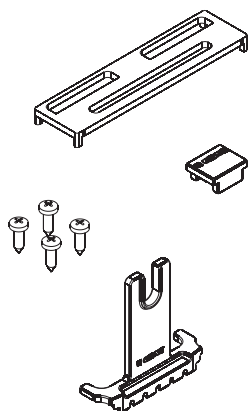

Art. 02410

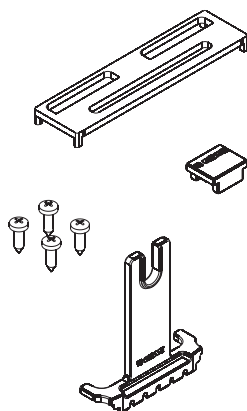

Art. 04071N

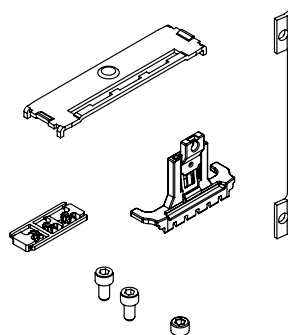

Art. 04080

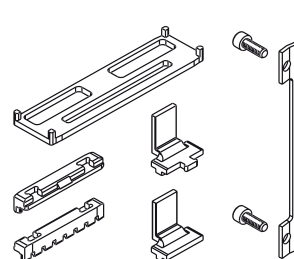

UNICA SYSTEM

| Item code | Description | PROFILE CROSS - SECTION | Type | Can be combined with | Operation | Pull handle 0° | Pull handle 90° | Pull handle 180° | Base Raw | Anodised Elox | Painted | Trend/Gold Brass | Pieces per pack |
|-----------|---|---|----------------------|---|-----------|----------------|-----------------|---------------------|----------|---------------|---------|------------------|-----------------|
| 02259 | APEX KIT FOR UNICA CREMONE | - | Outward Opening | 01063 - 01125 - 01126 - 01150N - 01151N | Two-way | closed | open | | X | | | | 20 |
| 02403 | KIT FOR OUT. OPENING UNICA SYSTEM SLIDER 28 | - | Outward Opening | 01063 - 01125 - 01126 - 01150N - 01151N - 011691 - 011692 | One-way | closed | open | | X | | | | 50 |
| 02407 | KIT FOR OUT. OPENING UNICA SYSTEM SLIDER 20 | - | Outward Opening | 01063 - 01125 - 01126 - 01150N - 01151N - 011691 - 011692 | One-way | closed | open | | X | | | | 50 |
| 02408 | KIT FOR OUT. OPENING UNICA SYSTEM SLIDER 35 | C001-C003-C016 | Outward Opening | 01063 - 01125 - 01126 - 01150N - 01151N - 011691 - 011692 | One-way | closed | open | | X | | | | 50 |
| 02409 | KIT FOR OUT. OPENING UNICA SYSTEM SLIDER 45 | C001-C013-C015 | Outward Opening | 01063 - 01125 - 01126 - 01150N - 01151N - 011691 - 011692 | One-way | closed | open | | X | | | | 50 |
| 02410 | KIT FOR OUT. OPENING UNICA SYSTEM SLIDER 55 | C001-C007- | Outward Opening | 01063 - 01125 - 01126 - 01150N - 01151N - 011691 - 011692 | One-way | closed | open | | X | | | | 50 |
| 04071N | UNICA SYSTEM TILT-AND-TURN WINDOW KIT | C001-C002-C003-C004-C005-C006-C007-C008-C009-C010-C012-C013-C014-C015-C016-C017 | Tilt-and-turn window | 01063 - 01125 - 01126 - 01150N - 01151N | One-way | closed | open | bottom-hung windows | X | | | | 50 |
| 04080 | KIT FOR IN. OPENING UNICA SYSTEM | C001-C002-C003-C004-C005-C006-C007-C008-C009-C010-C012-C013-C014-C015-C016-C017-P001-P002-P003-P004-P005-P006-P007-P008-P009-P010 | Sash | 01063 - 01125 - 01126 - 01150N - 01151N | Two-way | closed | open | | X | | | | 50 |