



**BRIO EVO SIDE DRIVE HANDLE**

**Functions**

It is applied in combination with another Brio Evo recessed handle. Recommended for use on heavy aluminium sliding doors/windows to facilitate handling of the sashes.

Online data sheet



**Technical Features**

The Brio Evo side drive handle has an ergonomic grip to facilitate handling of heavy doors and windows. Available in two versions with fixing in axis with the handle and a version with offset fixing, especially useful in the case of particularly heavy sashes, to avoid bending the wall. This article is designed to give unrestricted access to the recess of the recessed handle. Assembly is particularly fast, ensuring maximum durability.

**Materials**

Handle made of die-cast aluminium  
 HSCH screws in stainless steel  
 Rapid inserts in zinc plated steel  
 Screw cover caps in polyamide

**Parts**

- 2 TSE 6x16 screws
- 2 Rapid Inserts
- 2 Screw cover plugs

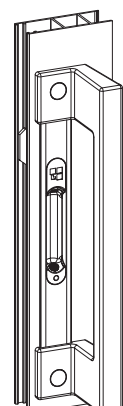
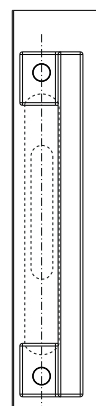
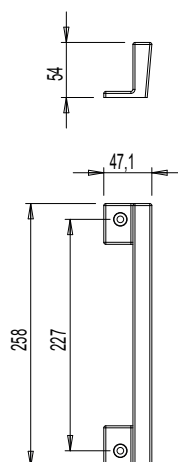
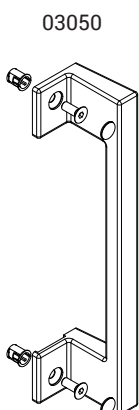
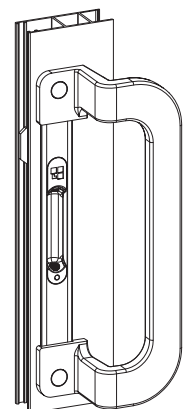
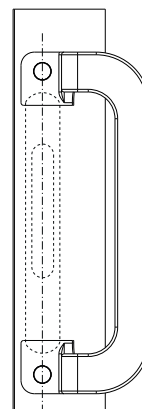
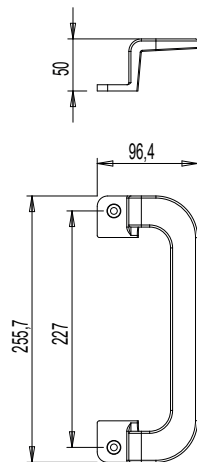
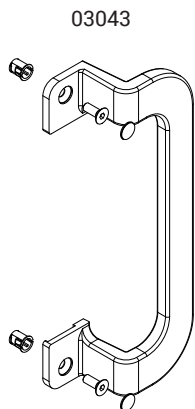

# INTERNAL PULL HANDLES

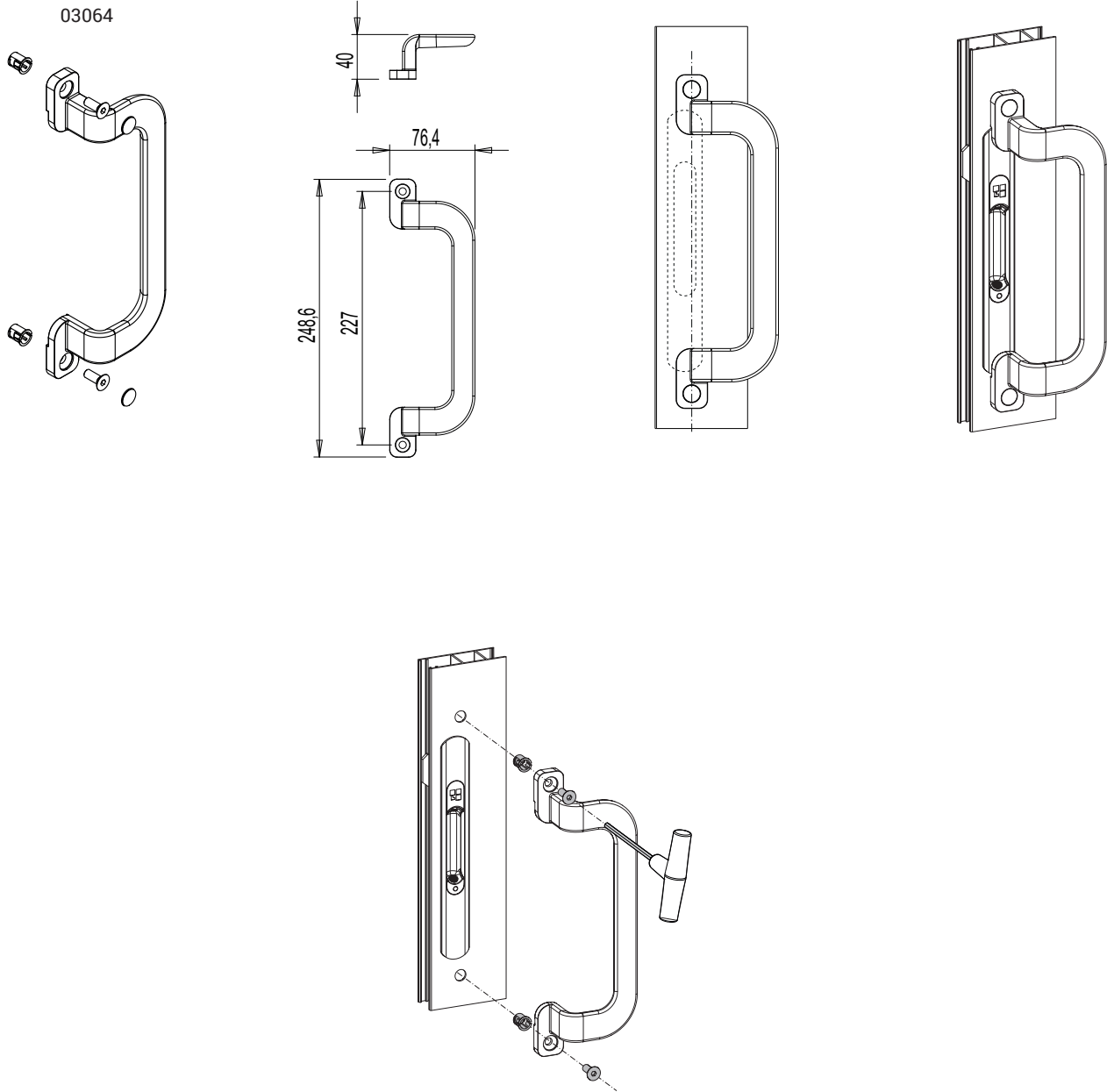

Item code	Description	Fixing	Base Raw	Anodised Elox	Painted	Trend/Gold Brass	Pieces per pack
03043	ROUNDED INTERNAL DRIVE HANDLE	centred	X		X	X	5
03050	SQUARE INTERNAL DRIVE HANDLE	centred	X		X	X	5
03064	SMALL ROUNDED INTERNAL DRIVE HANDLE	offset	X		X	X	5